

INSTITUTE FOR FISHERIES RESEARCH  
 DIVISION OF FISHERIES MICHIGAN CONSERVATION DEPT.

LAKE INVENTORY MAP  
**SPEAR LAKE**  
 AREA 24.3 ACRES

MARGINAL SURVEY AND SOUNDINGS 5/25/57  
 SHORE OUTLINE BASED ON U.S. DEPT. AGRIC. AERIAL PHOTO 7/9/41  
 LAPEER COUNTY T.8 N. R.9 E. SEC.34

- LEGEND**
- OUTLINE & CONTOURS**  
 — Shoreline  
 —5'— Contours
- SHORE FEATURES**  
 — Improved road  
 - - - - - Unimproved road  
 ~~~~~ Spring  
 ~~~~~ Encroaching shore  
 (W) Wooded  
 (PW) Partly wooded  
 (P) Pasture  
 (C) Cultivated  
 + Inlet  
 - - - - - Outlet

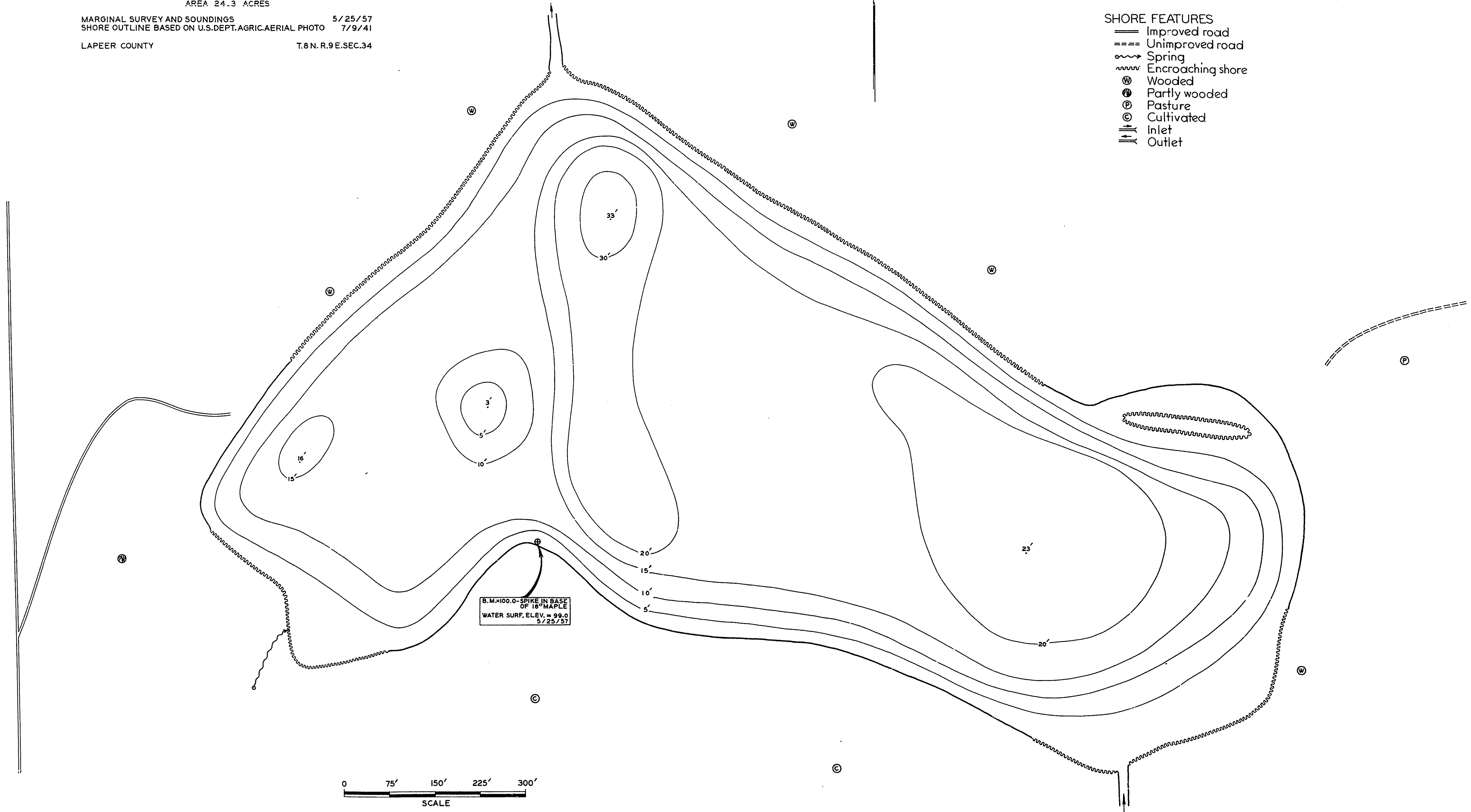
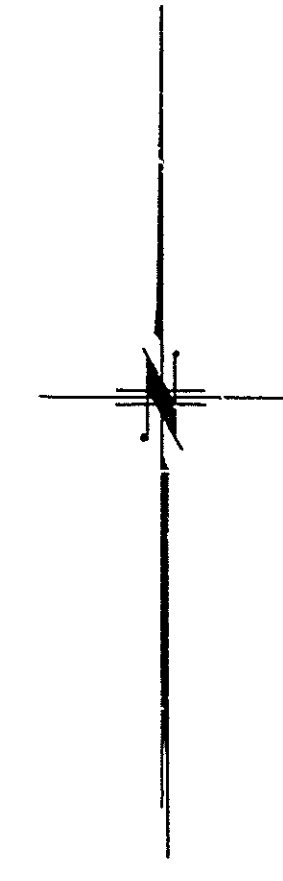

B.M. #100.0-SPIKE IN BASE  
 OF 18" MAPLE  
 WATER SURF. ELEV. = 99.0  
 5/25/57

