

INSTITUTE FOR FISHERIES RESEARCH
 DIVISION OF FISHERIES MICHIGAN CONSERVATION DEPT.
 LAKE INVENTORY MAP
PERCH LAKE
 AREA 23.7 ACRES
 MARGINAL SURVEY AND SOUNDINGS 1/16/46
 MARQUETTE COUNTY T. 45-46 N., R. 30 W., SEC'S. 4, 33

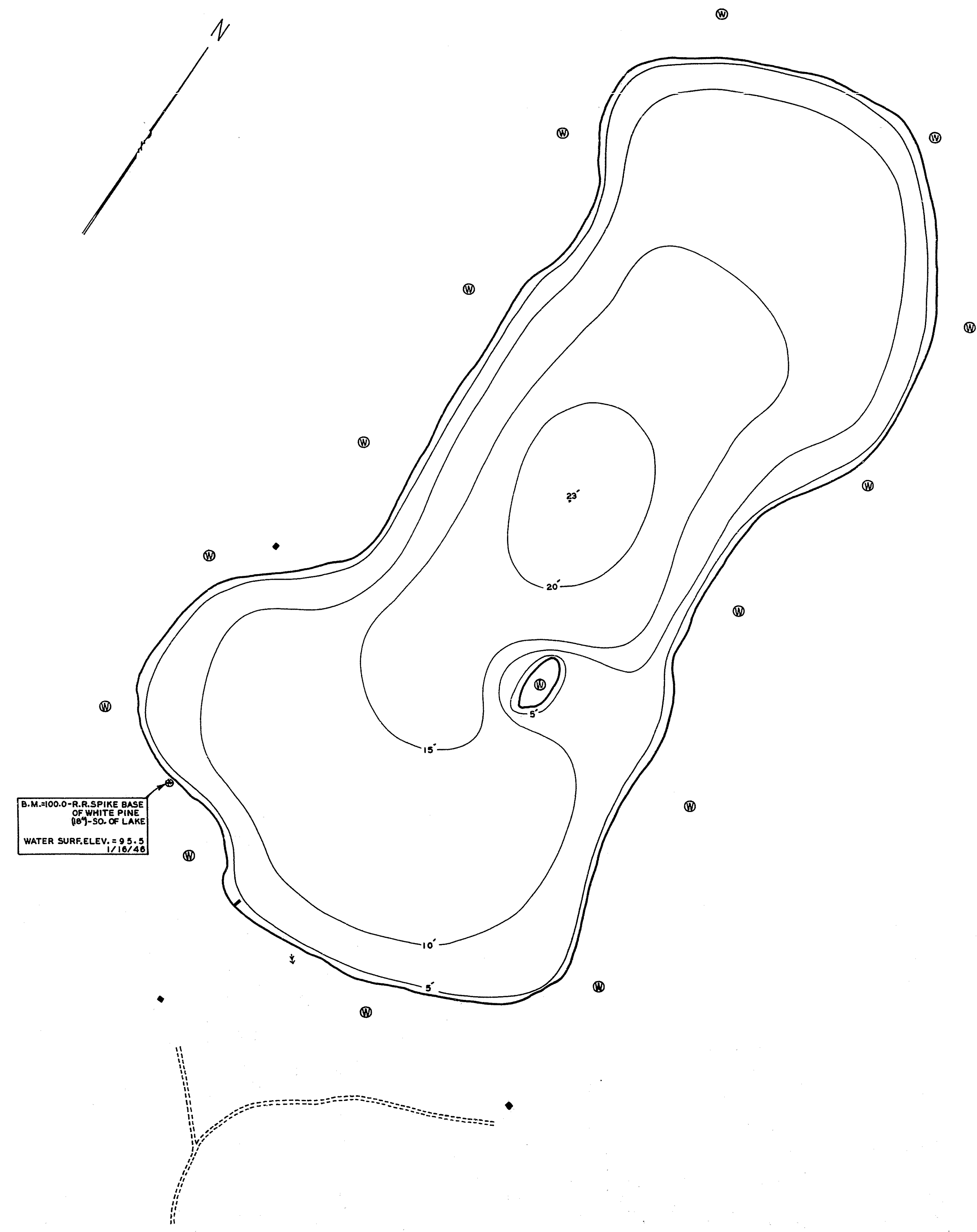
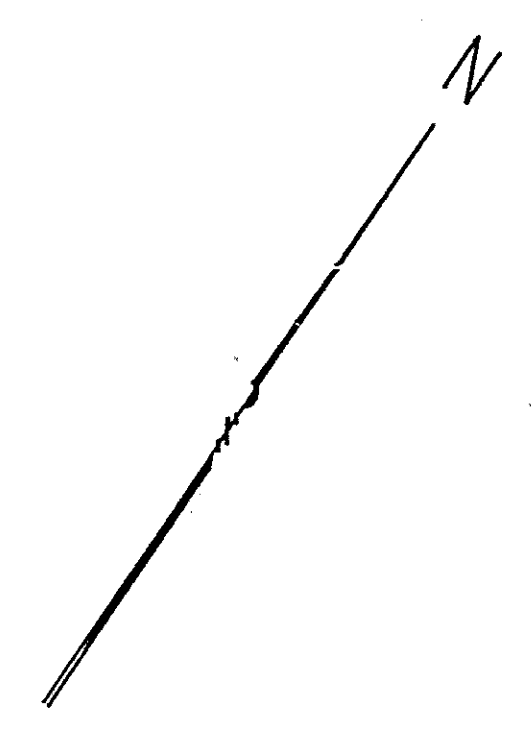

B.M. 100.0 - R.R. SPIKE BASE
 OF WHITE PINE
 (88') - SO. OF LAKE
 WATER SURF. ELEV. = 95.5
 1/16/46

LEGEND

- BOTTOM**
 □ Entire bottom Pulpypeat
- OUTLINE & CONTOURS**
 — Shoreline
 —5— Contours
- SHORE FEATURES**
 ■ Cottage
 — Dock
 === Unimproved road
 † Brush
 ⊙ Wooded

