

INSTITUTE FOR FISHERIES RESEARCH  
 DIVISION OF FISHERIES MICHIGAN CONSERVATION DEPT.  
 LAKE INVENTORY MAP  
**BELL MARIE & EMERALD LAKES**

MARGINAL SURVEY AND SOUNDINGS 9/1/53  
 (SHORE OUTLINE BASED ON U.S. DEPT. AGRIC. AERIAL PHOTO 10/27/38)  
 OTSEGO COUNTY T. 29 N., R. 2-3 W. SEC'S 1, 6

**LEGEND**

**BOTTOM**

- Sand
- Marl
- Pulpy peat
- Fibrous peat
- Muck
- Gravel

**OUTLINE & CONTOURS**

- Shoreline
- Contours

**SHORE FEATURES**

- Slope
- Unimproved road
- Trail
- Marsh
- Brush
- Encroaching shore
- Wooded
- Beaver dam
- Inlet
- Outlet

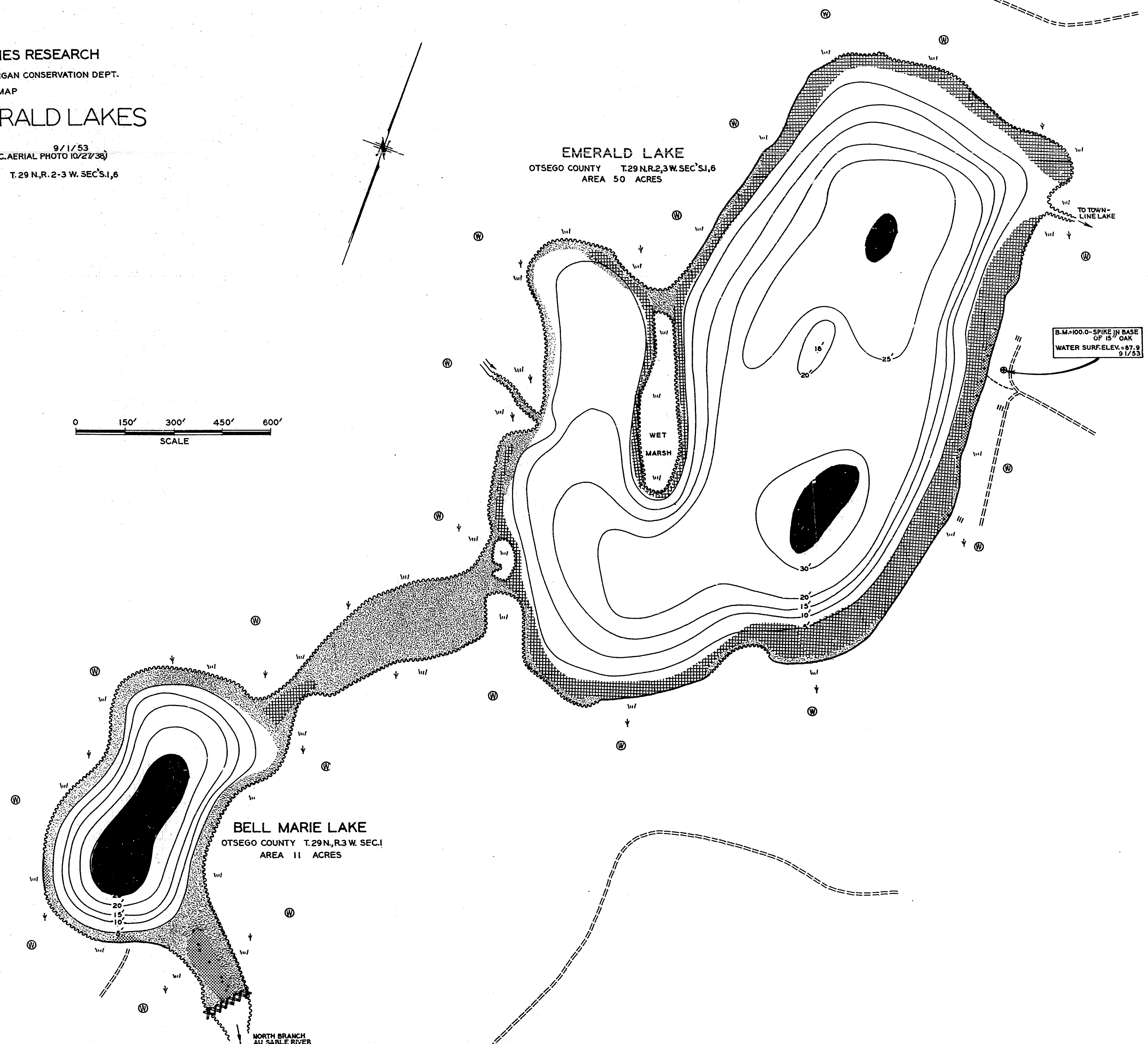

**BELL MARIE LAKE**  
 OTSEGO COUNTY T. 29 N., R. 3 W. SEC. 1  
 AREA 11 ACRES

**EMERALD LAKE**  
 OTSEGO COUNTY T. 29 N., R. 2, 3 W. SEC'S 1, 6  
 AREA 50 ACRES

B.M. 100-0 SPIKE IN BASE  
 OF 15" OAK  
 WATER SURF. ELEV. = 87.9  
 9/1/53

NORTH BRANCH  
 AU SABLE RIVER