

Resurvey
Township 44 N. Range 19 W. Mer. Mich.

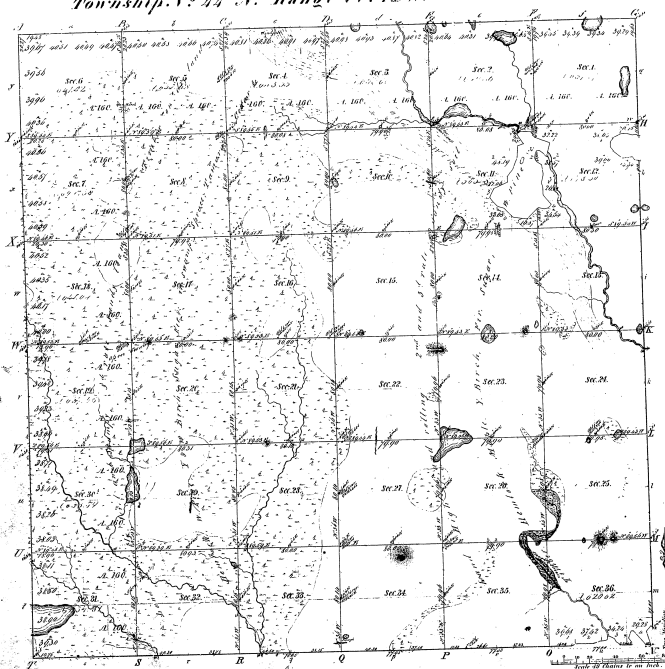

Boundaries of
 Public Courses 1841 Public Courses 1842 Public Courses 1843

37-23

37-23

Total number of Acres 2,122.36

Acres designated	By Whom Surveyed	Date of Survey	Amount of Acres	When Surveyed	By Whom Surveyed
2,122.36	Geo. W. Adams	April 2, 1843	2,122.36	2 nd Quarter 1843	Geo. W. Adams
	A. Montgomery	5, 19, 1843	2,122.36	2 nd Quarter 1843	A. Montgomery

The above map of Township 44 North Range 19 West of the Principal Meridian of Michigan is truly and correctly the full and true survey thereof as filed in the office of the Register and approved.

Register General's Office
 Detroit May 27 1843

David Johnson
 Surveyor

Exam. Copy made
 Nov. 1855

TOWNSHIP 44 NORTH, RANGE 19 WEST, OF THE MICHIGAN MERIDIAN, MICHIGAN
 SURVEY OF ISLANDS IN SECTION II.

37-23

37-23

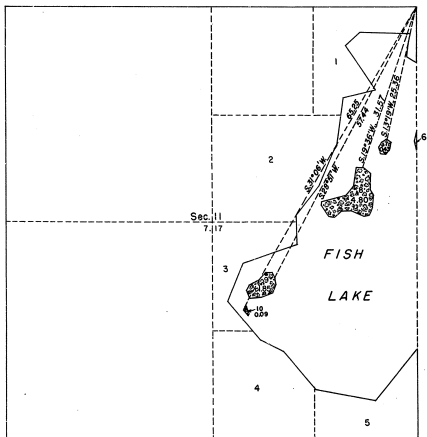

This plat represents the survey of four islands in Fish Lake which were not included in the original survey of the township which is represented on the plat approved May 21, 1856.

Survey executed by Hugh B. Crawford, Cadastral Engineer, from November 14 to 15, 1949, under special instructions for Group 56, dated October 23, 1946.

AREA SURVEYED: 7.17 ACRES



UNITED STATES DEPARTMENT OF THE INTERIOR
 BUREAU OF LAND MANAGEMENT

Washington, D. C., August 1, 1950
 This plat is strictly conformable to the approved field notes, and the survey, having been correctly executed in accordance with the requirements of law and the regulations of this Bureau, is hereby accepted.

For the Director
William F. Roberts
 Chief, Branch of Surveys