

Township 1° 41' N Range 1° 35' W Mer. Mich.

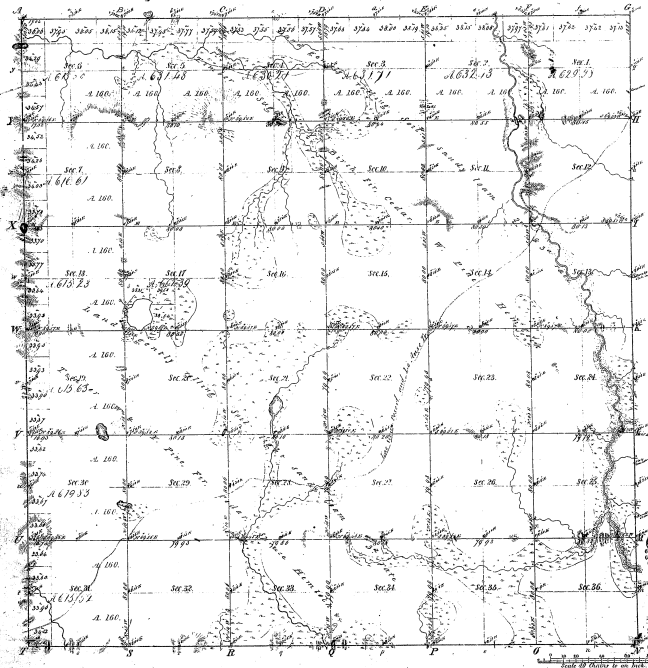

Boundaries of

Section	Acres	Section	Acres	Section	Acres
1	229.53	13	171	25	171
2	171	14	171	26	171
3	171	15	171	27	171
4	171	16	171	28	171
5	171	17	171	29	171
6	171	18	171	30	171
7	171	19	171	31	171
8	171	20	171	32	171
9	171	21	171	33	171
10	171	22	171	34	171
11	171	23	171	35	171
12	171	24	171	36	171

44-15

Total number of acres 229 1/2 40

Survey Designated	By Whom Surveyed	Date of Commencement	Amount of Survey	When Surveyed	How far and in what direction from the Section
Township Lines	W. H. H. H. H.	April 22, 1840	36	1840	...
Section Lines	W. H. H. H. H.	April 22, 1840	36	1840	...

The above Map of Township 1° 41' N Range 1° 35' W of the Principal Meridian of Michigan is hereby approved by the Public Lands Survey General Office of Michigan and approved by the Survey General Office of Michigan on the 10th day of April 1883.

Survey General Office
 Edward Chapman
 1883