

Township N^o 48 N. Range N^o 33 W. Mer. Mich.

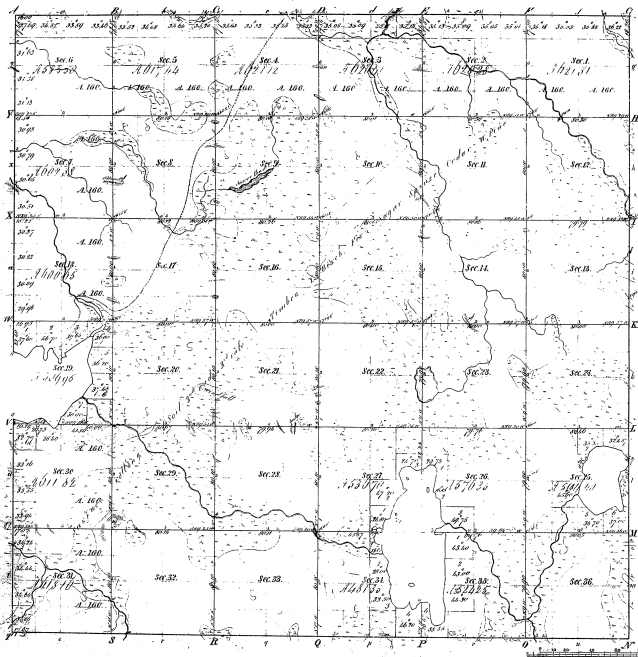

Meanders of	
North Course 48 th 1/2'	North Course 48 th 1/2'
44-12	44-12

Total number of Acres 21,451.04		
Survey designated	By Whom Surveyed	Date of Contract
Township, Range	N ^o 48 N. & W. 33 W.	1871
Subdivisions	Sections 8, 10, 12, 14, 16, 18, 20, 22, 24, 26, 28, 30, 32, 34, 36	6 th 20 th 1871

The above copy of Township N^o 48 North of Range N^o 33 West of the Principal Meridian Michigan is a faithful representation of the field notes of the Surveyors and is the only official true and correct map approved by the State of Michigan.

Wm. H. Hunt
 S. C. Chapman
 Surveyors

Township 1° 48' N. Range 1° 33' W. Mer. Mich.

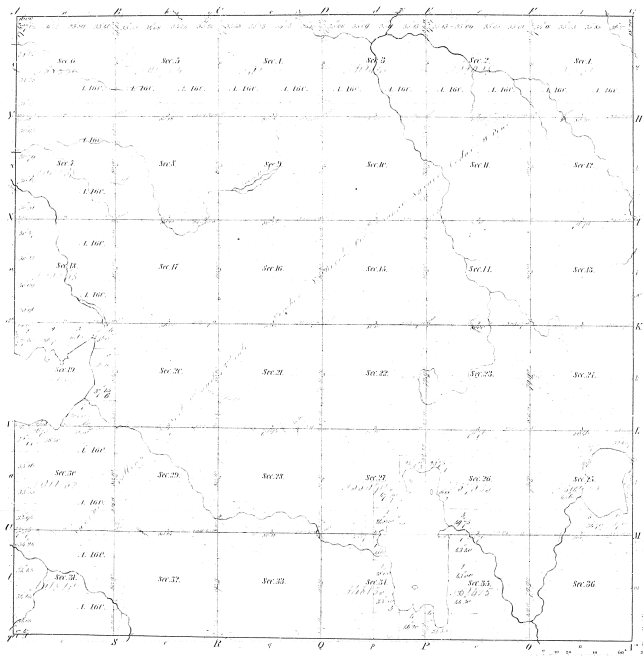

Boundaries of
Public Lands, 48-48' North Range, 48-33' West Township, 48-48'

114-1-2

Total number of Acres

Section designated	By whom surveyed	Date of survey	Amount of Acres	When surveyed
Township lines	W. A. Chapman, Dec. 1856	1856	36	1856
Subdivisions	W. A. Chapman, Dec. 1856	1856	1287 1/2	1856
			1323 1/2	1856

The above copy of Township 1° 48' North Range 1° 33' West of the Principal Meridian Michigan is a strictly correct and true copy of the survey thereon in the original for which has been examined and approved
 W. A. Chapman
 Surveyor General of Michigan
 1856

TOWNSHIP N° 48 NORTH, RANGE N° 33 WEST, OF THE MICHIGAN MERIDIAN, MICHIGAN.
 PLAT OF AN ISLAND IN KING LAKE IN SECTION 27.

44-12

44-12

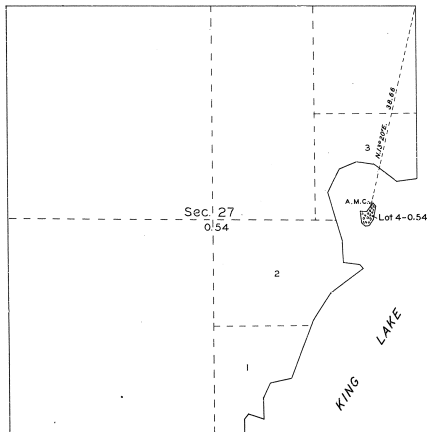

MEMORANDUM

THIS PLAT REPRESENTS THE SURVEY OF AN ISLAND IN KING LAKE, WHICH WAS NOT SHOWN UPON THE TOWNSHIP PLAT APPROVED JUNE 1, 1905. THE SURVEY WAS DELETED PURSUANT TO AUTHORITY CONTAINED IN GENERAL LAND OFFICE LETTER 137635 "B", DATED AUGUST 19, 1930, WHICH BEARS DEPARTMENTAL APPROVAL DATED AUGUST 21, 1930.

OFFICE OF THE SUPERVISOR OF SURVEYS
 DENVER, COLORADO, JANUARY 5, 1932.

THE ABOVE PLAT OF AN ISLAND IN KING LAKE IN SECTION 27, TOWNSHIP NO. 48 NORTH, RANGE NO. 33 WEST, MICHIGAN MERIDIAN, IN THE STATE OF MICHIGAN, IS STRICTLY CONFORMABLE TO THE FIELD NOTES OF THE SURVEY THEREOF, WHICH HAVE BEEN EXAMINED AND APPROVED.

Wm. D. Johnson
 U. S. SUPERVISOR OF SURVEYS.

DEPARTMENT OF THE INTERIOR
 GENERAL LAND OFFICE

WASHINGTON, D. C., JANUARY 13, 1932.

THE SURVEY REPRODUCED BY THIS PLAT, HAVING BEEN CORRECTLY DELETED IN ACCORDANCE WITH THE REQUIREMENTS OF LAW AND THE REGULATIONS OF THIS OFFICE, IS HEREBY ACCEPTED.

W. C. Chandler
 ASSISTANT COMMISSIONER.

SCALE: 10 CHAINS TO AN INCH. AREA SURVEYED, 0.54 ACRES.

LINES DESIGNATED	BY WHOM SURVEYED	GROUP		MILEAGE		WHEN SURVEYED	
		NO.	DATE	MLS.	CHS.	BEGUN	COMPLETED
MEANDERS	JOS. C. THOMA.	26	JUNE 10,	0	11.24	JULY 28,	JULY 28,
CONNECTION	U.S.C. ENGINEER.		1931.	0	36.66	1931.	1931.