



TOWNSHIP N° 49 NORTH, RANGE N° 31 WEST, OF THE MICHIGAN MERIDIAN, MICHIGAN.

PLAT OF AN ISLAND IN CAMP NINE LAKE IN SECTION 33.

45-7

45-7

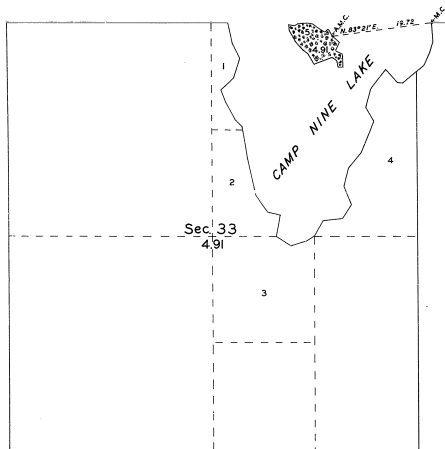

MEMORANDUM

THIS PLAT REPRESENTS THE SURVEY OF AN ISLAND IN CAMP NINE LAKE, WHICH WAS NOT SHOWN UPON THE TOWNSHIP PLAT APPROVED DECEMBER 22, 1852. THIS SURVEY WAS SELECTED PURSUANT TO APPROVITT CONTAINED IN ORIGINAL LAND OFFICE LETTER 135813 \*P\*, DATED JANUARY 5, 1931 WHICH BEARS DEPARTMENTAL APPROVAL DATED JANUARY 30, 1931.

OFFICE OF THE SUPERVISOR OF SURVEYS  
DESOTO, OREGON, JANUARY 5, 1932.

THE ABOVE PLAT OF AN ISLAND IN CAMP NINE LAKE IN SECTION 33, TOWNSHIP NO. 49 NORTH, RANGE NO. 31 WEST, MICHIGAN MERIDIAN, IN THE STATE OF MICHIGAN, IS STRICTLY CORRESPONDING TO THE FIELD NOTES OF THE SURVEY THEREOF, WHICH HAVE BEEN EXAMINED AND APPROVED.

*Samuel W. Warner*  
U. S. SUPERVISOR OF SURVEYS.

DEPARTMENT OF THE INTERIOR  
ORIGINAL LAND OFFICE  
WASHINGTON, D. C., JANUARY 13, 1932.

THE SURVEY REPRESENTED BY THIS PLAT, HAVING BEEN CORRECTLY EXECUTED IN ACCORDANCE WITH THE REQUIREMENTS OF LAW AND THE REGULATIONS OF THIS OFFICE, IS HEREBY APPROVED.

*Wm. C. Howell*  
ASSISTANT COMMISSIONER.

SCALE: 10 CHAINS TO AN INCH.

AREA SURVEYED: 4.91 ACRES.

LINES DESIGNATED	BY WHOM SURVEYED	GROUP		MILEAGE		WHEN SURVEYED	
		NO.	DATE	M-S.	CHS.	BEGUN	COMPLETED
MEANDERS	JOSEPH C. THOMA, U. S. C. ENGINEER	26	JUNE 10, 1931.	0	33.11	JULY 29 1931.	JULY 29, 1931.
CONNECTION				0	19.72		