

Township N. III North, Range N. VIII West Mer. (M^{ts} Ter.)

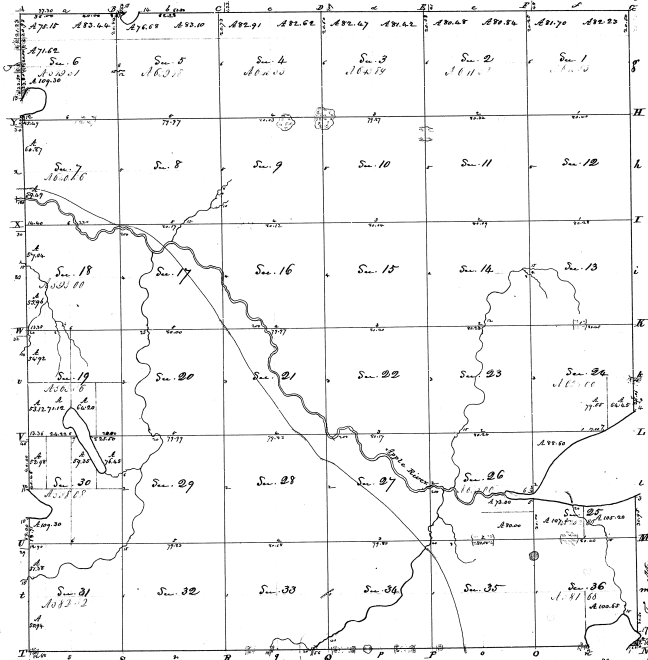

Surveyed in November 1830 - by Sylvester Abbley S^r.

Sections		Acres		Cup Cont.		Acres	
Sec. 1	81.23	81	23	Sec. 20	64.00	64	00
Sec. 2	81.70	81	70	Sec. 21	64.00	64	00
Sec. 3	81.23	81	23	Sec. 22	64.00	64	00
Sec. 4	81.70	81	70	Sec. 23	64.00	64	00
Sec. 5	81.23	81	23	Sec. 24	64.00	64	00
Sec. 6	81.70	81	70	Sec. 25	64.00	64	00
Sec. 7	81.23	81	23	Sec. 26	64.00	64	00
Sec. 8	81.70	81	70	Sec. 27	64.00	64	00
Sec. 9	81.23	81	23	Sec. 28	64.00	64	00
Sec. 10	81.70	81	70	Sec. 29	64.00	64	00
Sec. 11	81.23	81	23	Sec. 30	64.00	64	00
Sec. 12	81.70	81	70	Sec. 31	64.00	64	00
Sec. 13	81.23	81	23	Sec. 32	64.00	64	00
Sec. 14	81.70	81	70	Sec. 33	64.00	64	00
Sec. 15	81.23	81	23	Sec. 34	64.00	64	00
Sec. 16	81.70	81	70	Sec. 35	64.00	64	00
Sec. 17	81.23	81	23	Sec. 36	64.00	64	00
Sec. 18	81.70	81	70				
Sec. 19	81.23	81	23				
Sec. 20	81.70	81	70				
Sec. 21	81.23	81	23				
Sec. 22	81.70	81	70				
Sec. 23	81.23	81	23				
Sec. 24	81.70	81	70				
Sec. 25	81.23	81	23				
Sec. 26	81.70	81	70				
Sec. 27	81.23	81	23				
Sec. 28	81.70	81	70				
Sec. 29	81.23	81	23				
Sec. 30	81.70	81	70				
Sec. 31	81.23	81	23				
Sec. 32	81.70	81	70				
Sec. 33	81.23	81	23				
Sec. 34	81.70	81	70				
Sec. 35	81.23	81	23				
Sec. 36	81.70	81	70				
				Total		12379.88	
						12379.88	
						12379.88	

6-32