

Re-Survey
Township N^o. 16 N. Range N^o. 4 East Mer. (Mich.)

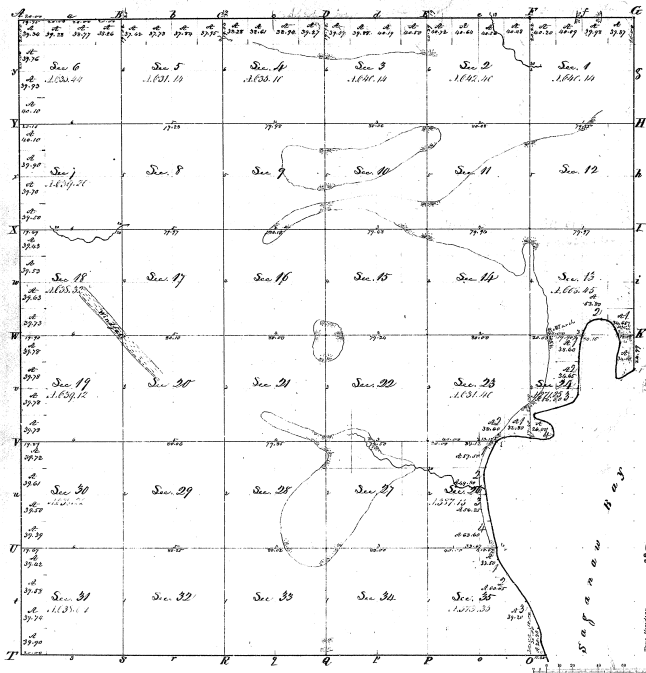

Schedule of Subsequent Blows					
Blow	Course	Dist	Course	Dist	Course
1	S 68° 07'	18.85	S 68° 07'	18.85	
	S 70° 00'	18.70	S 70° 00'	18.70	
	S 72° 00'	18.55	S 72° 00'	18.55	
	S 74° 00'	18.40	S 74° 00'	18.40	
2	N 10° 00'	11.68	N 10° 00'	11.68	
	N 12° 00'	11.52	N 12° 00'	11.52	
	N 14° 00'	11.36	N 14° 00'	11.36	
	N 16° 00'	11.20	N 16° 00'	11.20	
	N 18° 00'	11.04	N 18° 00'	11.04	
3	S 70° 00'	28.00	S 70° 00'	28.00	
	S 72° 00'	27.84	S 72° 00'	27.84	
	S 74° 00'	27.68	S 74° 00'	27.68	
	S 76° 00'	27.52	S 76° 00'	27.52	
	S 78° 00'	27.36	S 78° 00'	27.36	
	S 80° 00'	27.20	S 80° 00'	27.20	
4	N 10° 00'	11.68	N 10° 00'	11.68	
	N 12° 00'	11.52	N 12° 00'	11.52	
	N 14° 00'	11.36	N 14° 00'	11.36	
	N 16° 00'	11.20	N 16° 00'	11.20	
	N 18° 00'	11.04	N 18° 00'	11.04	
5	S 70° 00'	28.00	S 70° 00'	28.00	
	S 72° 00'	27.84	S 72° 00'	27.84	
	S 74° 00'	27.68	S 74° 00'	27.68	
	S 76° 00'	27.52	S 76° 00'	27.52	
	S 78° 00'	27.36	S 78° 00'	27.36	
	S 80° 00'	27.20	S 80° 00'	27.20	

Total number of Acres					
Survey designated	By whom surveyed	Date of survey	Amount of Survey	When changed to the Survey	When changed to the Survey
Township Survey	Wright & Smith	May 27, 1823	66.67.90	1823	1823
Subdivisions	John Smith	May 27, 1823	5.75.00	1823	1823

I, the above Rep^y of Township N^o. 16 North of Range N^o. 4 East fifth Principal Meridian Michigan is fully responsible to the said area of the survey being on file in this Office, which have been examined and approved.

Surveyor General's Office.
 Cincinnati, Sept. 30, 1823.

92-17