

Township N. VI south, Range N. XVII West Abn. (Mi. Ter.) 122

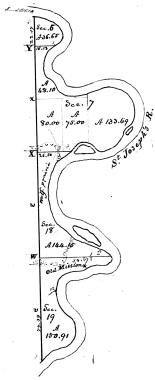

SW/4	Sec. 5	36.65
NE/4	Sec. 7	133.89
NE/4	Sec. 10	58.10
SE/4	Sec. 10	28.00
NE/4	Sec. 11	70
NE/4	Sec. 12	104.17
NE/4	Sec. 13	120.91
NE/4	Sec. 14	68.50

Scale 1" = 100'

Surveyed August 24, 1929, by Lucius Spry S.S.

1-2-2

