

Township N. VII south, Range N. XVIII west Mer. (Mic. Tor.)

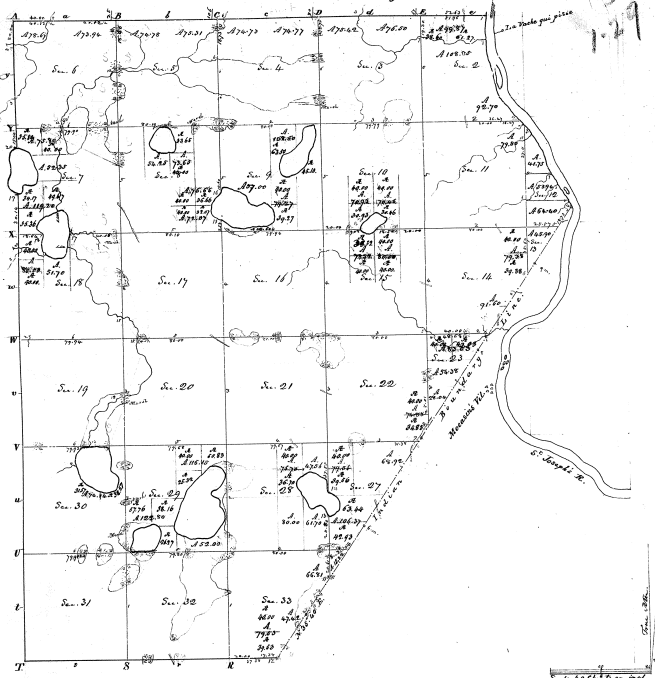

Surveyed in November 1829 by James Lyon & Co.

Section		Contents	
Acres	Value	Acres	Value
Sec 6 NW 2	27 77	Sec 7 SE 14	79 38
Sec 6	148 82	Sec 7	80
Sec 8 SE	92 74	Sec 8 SE	91 64
Sec 8 NW	160	Sec 9 NW	220
Sec 10 SE	74 20	Sec 10 SE 15	80
Sec 10	89	Sec 10 NW	78 32
Sec 10 NW	75 62	Sec 11	90
Sec 11	80	Sec 11	320
Sec 11	220	Sec 11	600
Sec 12 SE 4	74 77	Sec 11	19
Sec 12	80	Sec 11	600
Sec 12 NW	74 73	Sec 11	57 70
Sec 12	80	Sec 11	180
Sec 12	320	Sec 11	600
Sec 12 SE 5	72 31	Sec 11	20
Sec 12	80	Sec 11	600
Sec 12 NW	74 73	Sec 11	21
Sec 12	80	Sec 11	320
Sec 12	320	Sec 11	20
Sec 12 SE 6	72 74	Sec 11	21
Sec 12	80	Sec 11	600
Sec 12 NW	78 07	Sec 11	160
Sec 12	80	Sec 11	68 92
Sec 12	160	Sec 11	20
Sec 12 NW	80	Sec 11	79 56
Sec 12	80	Sec 11	160 37
Sec 12 NW	320	Sec 11	47 78
Sec 12 NW 7	70 80	Sec 11	76 70
Sec 12	82 25	Sec 11	41 70
Sec 12 NW	119 80	Sec 11	80
Sec 12 SE 8	80	Sec 11	320
Sec 12	75 52	Sec 11	116 15
Sec 12 NW	58 25	Sec 11	160
Sec 12	80	Sec 11	32 00
Sec 12 SE 8	74 66	Sec 11	122 80
Sec 12	72 07	Sec 11	70 16
Sec 12	160	Sec 11	320
Sec 12 SE 9	108 60	Sec 11	600
Sec 12	160	Sec 11	66 51
Sec 12	79 27	Sec 11	80
Sec 12 NW	57 00	Sec 11	160
Sec 12	10 60	Sec 11	66 51
Sec 12	320	Sec 11	160
Sec 12 SE 10	80	Sec 11	46 62
Sec 12	70 66	Sec 11	79 53
Sec 12 NW	70 93	Sec 11	80
Sec 12	80	Sec 11	15 00
Sec 12 SE 11	79 50	Sec 11	83 03
Sec 12	80	Sec 11	52 38
Sec 12	160	Sec 11	28 00
Sec 12	320	Sec 11	85 20
Sec 12	41 75	Sec 11	611 51
Sec 12 NW	53 94	Sec 11	1,566 15
Sec 12	64 60	Sec 11	
Sec 12	45 90	Sec 11	
Sec 12	5,115 00	Sec 11	

68-1

T 7 South R 18 West Mich

1-24

Section	Acres	Value
1	36.00	1.00
2	36.00	1.00
3	36.00	1.00
4	36.00	1.00
5	36.00	1.00
6	36.00	1.00
7	36.00	1.00
8	36.00	1.00
9	36.00	1.00
10	36.00	1.00
11	36.00	1.00
12	36.00	1.00
13	36.00	1.00
14	36.00	1.00
15	36.00	1.00
16	36.00	1.00
17	36.00	1.00
18	36.00	1.00
19	36.00	1.00
20	36.00	1.00
21	36.00	1.00
22	36.00	1.00
23	36.00	1.00
24	36.00	1.00

1-29

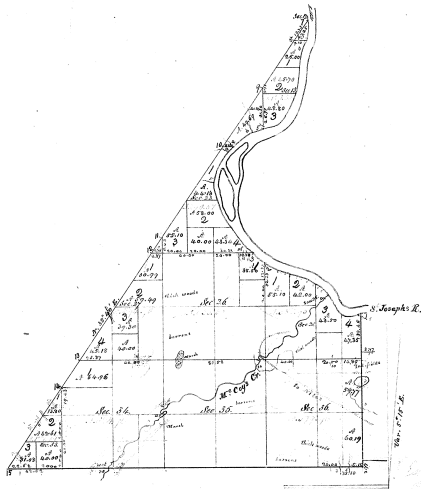

Survey	Original	By whom changed	Date of Re-survey	Section	Value	When changed	Value
Traverse	Survey	Robert Clark	23.0. July 1835	6, 7, 11, 14	1.00	6.0. 1835	6.0. 1835
Declaration	Survey	Robert Clark	23.0. July 1835	10, 12, 15, 16	1.00	6.0. 1835	6.0. 1835

The above Map of Township No. 7 South of Range No. 18 W. of the Meridian (Mich. Ter.) is strictly conformable to the files & records of the Survey thereof on file in this Office which have been examined & approved.
 Surveyor General's Office
 Detroit Mich.

Township N^o VII south, Range N^o XVIII west Mer. (Mio. Ter.)

1-21

4

1-29

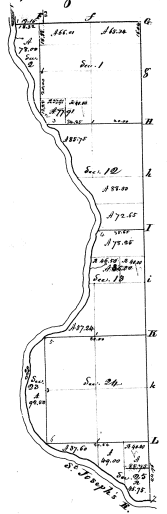

Section	Area
1	64.00
2	64.00
3	64.00
4	64.00
5	64.00
6	64.00
7	64.00
8	64.00
9	64.00
10	64.00
11	64.00
12	64.00
13	64.00
14	64.00
15	64.00
16	64.00
17	64.00
18	64.00
19	64.00
20	64.00
21	64.00
22	64.00
23	64.00
24	64.00
25	64.00
26	64.00
27	64.00
28	64.00
29	64.00
30	64.00
31	64.00
32	64.00
33	64.00
34	64.00
35	64.00
36	64.00
Total	2304.00

L. Green 1847

