

Township N. VIII south, Range N. V west (Ms. Ter.)

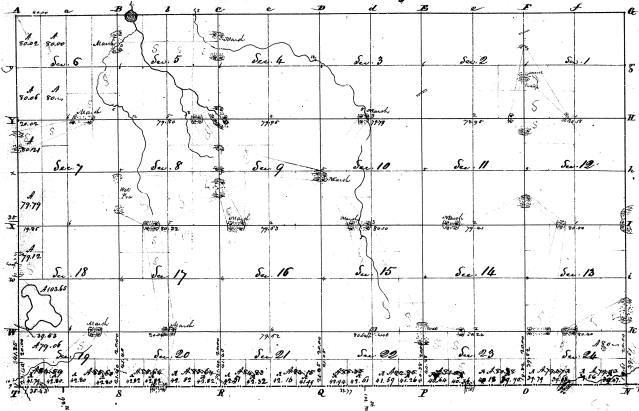

Surveyed in April 1888 - by Albert Clark and S. J. S.

Scale 60 Ch. to an inch

Subtotals		Counters	
Sections	Acres	Sections	Acres
Sec. 1	640		
2	640		
3	640		
4	640		
5	640		
6	640		
7	640		
8	640		
9	640		
10	640		
11	640		
12	640		
13	640		
14	640		
15	640		
16	640		
17	640		
18	640		
19	640		
20	640		
21	640		
22	640		
23	640		
24	640		
25	640		
26	640		
27	640		
28	640		
29	640		
30	640		
31	640		
32	640		
33	640		
34	640		
35	640		
36	640		
Total	23040		

H-37

H-32