



64.2

*Islands in Kalamazoo River*

*Township N° 1 S Range N° 8 W. Mer. Mich.*

3-3

2

3-3

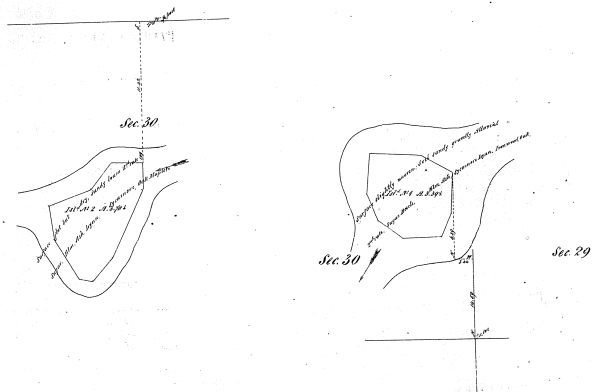

*Surveyed by T. H. Wadley (under Instructions May 26<sup>th</sup> 1856) in 1856*

*Scale 2 Chains to an Inch. See 2nd N.*

*The above Map of Township N° 1 South of Range N° 8 West of the  
 Principal Meridian of Michigan is strictly conformable to the Field Notes  
 of the Survey thereon on file in this Office which have been examined and approved  
 Survey General's Office  
 Detroit April 15<sup>th</sup> 1857*

*A. C. Cooper  
 Sur. Genl.*