

Islands in Lake
Township N° 2 S. Range N° 8 W. Mer. Mich.

3-16

3-180

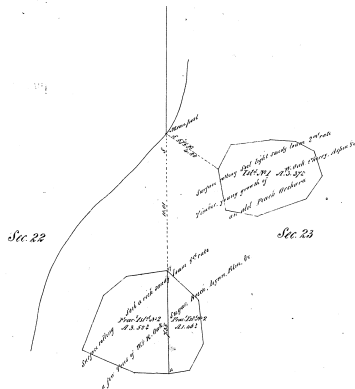

Surveyed by Thos. Whitely (under Instructions May 26th 1836) in 1836

Scale & Chains is an Inch = 2 1/2 mi

*The above Map of Township N° 2 South of Range N° 8 West of the
 Principal Meridian of Michigan is truly conformable to the field notes
 of the Survey shown on file in this Office which have been examined and approved
 Surveyor General's Office
 Detroit, April 15th 1854*

C. D. Emerson Surveyor General

Plat of Two Islands in Kalamazoo River, Sec. 2, T.2S., R.8W., Mich. Mer., Michigan.

3-18
3-18

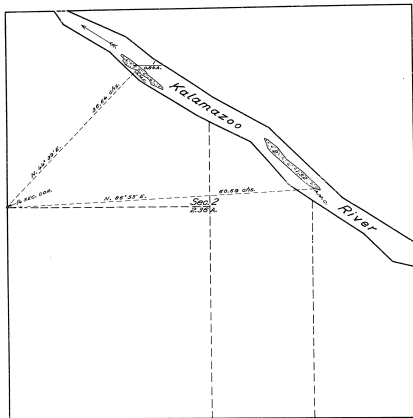

LEGEND.

Scale: 1 inch = 10 chains.

Surveyed by Hal D. Craig, U. S. Surveyor, from October 29 to November 2, 1905, inclusive, under special Instructions for Group No. 11, Michigan, dated July 16, 1905, issued by Frank M. Johnson, Supervisor of Surveys, which were approved by the Commissioner of the General Land Office on August 4, 1905.

Area of lands surveyed = 2.36 Acres, not shown upon the original plat approved July 14, 1876.

Areas of previously surveyed lands not shown.

Office of U. S. Supervisor of Surveys,
Denver, Colorado, September 8, 1906.

The above plat of two Islands in Kalamazoo River in Section 2, Town No. 2 South, Range No. 8 West, of the Michigan Meridian, in the State of Michigan, is strictly conformable to the field notes of the survey thereof, which have been examined and approved.

U. S. Supervisor of Surveys.

DEPARTMENT OF THE INTERIOR,
GENERAL LAND OFFICE.

Washington, D. C., January 26, 1907.

The survey represented by this plat, having been correctly executed in accordance with the requirements of law and the regulations of this office, is hereby accepted.

Acting Assistant Commissioner.