

Township N. IV south, Range N. II West Mer. (Mic. Ter.)

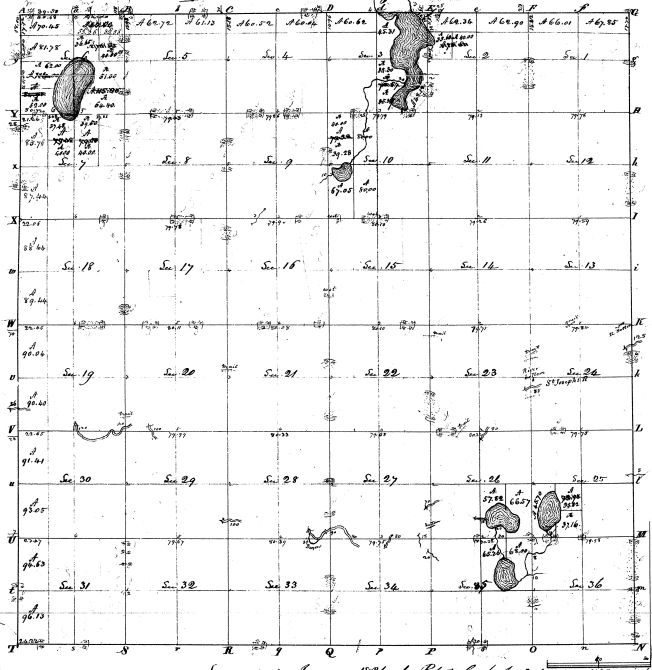

Surveyed in January 1886. by Robert Clark Jr. & L. J. ...

3-26

Location	Quantity	Kind	Quantity
S. 1 E. 1	67 52	E. 1/2 NW	18
S. 2 NW	66 01	NW	50
S. 3 E. 2	30	E. 1/2 NW	88 64
S. 4 NW	32 00	NW	50
S. 5 E. 3	22 90	E. 1/2 NW	32 00
S. 6 NW	50	NW	50
S. 7 E. 4	68 36	E. 1/2 NW	50
S. 8 NW	70 60	NW	50
S. 9 E. 5	32 00	NW	90 60
S. 10 NW	4 27	NW	60 00
S. 11 E. 6	6 51	NW	80 00
S. 12 NW	60 62	NW	20 60 00
S. 13 E. 7	50	NW	33 60 00
S. 14 NW	48 78	NW	26 60 00
S. 15 E. 8	70 67	E. 1/2 NW	25 30 00
S. 16 NW	160	NW	160
S. 17 E. 9	60 00	E. 1/2 NW	75 50
S. 18 NW	50	NW	45 50
S. 19 E. 10	60 58	NW	30 00
S. 20 NW	30	E. 1/2 NW	66 57
S. 21 E. 11	32 00	NW	20 00
S. 22 NW	61 13	NW	160
S. 23 E. 12	50	NW	27 50
S. 24 NW	67 72	NW	28 60 00
S. 25 E. 13	50	NW	20 00
S. 26 NW	240	E. 1/2 NW	30 00
S. 27 E. 14	65 60	E. 1/2 NW	30
S. 28 NW	50	NW	91 01
S. 29 E. 15	70 00	E. 1/2 NW	93 05
S. 30 NW	51 78	NW	31 00
S. 31 E. 16	116 00	E. 1/2 NW	90 60
S. 32 NW	146 00	NW	50
S. 33 E. 17	79 50	E. 1/2 NW	70 10
S. 34 NW	80	NW	33 60 00
S. 35 E. 18	87 76	NW	59 60 00
S. 36 NW	50	NW	33 60 00
S. 37 E. 19	87 60	E. 1/2 NW	36 60 00
S. 38 NW	60 00	NW	58 00
S. 39 E. 20	30	NW	65 36
S. 40 NW	30	E. 1/2 NW	160
S. 41 E. 21	30	NW	30 00
S. 42 NW	30	NW	26 60 00
S. 43 E. 22	30	NW	10 10 17
S. 44 NW	67 05	NW	10 10 17
S. 45 E. 23	60 00	NW	9 20 26
S. 46 NW	13 60 00	NW	9 20 26
S. 47 E. 24	15 60 00	NW	1 41 57
S. 48 NW	16 60 00	NW	2 20 57
S. 49 E. 25	17 60 00	NW	2 20 57
S. 50 NW	17 60 00	NW	2 20 57
S. 51 E. 26	18 60 00	NW	2 20 57
S. 52 NW	19 60 00	NW	2 20 57
S. 53 E. 27	20 60 00	NW	2 20 57
S. 54 NW	21 60 00	NW	2 20 57
S. 55 E. 28	22 60 00	NW	2 20 57
S. 56 NW	23 60 00	NW	2 20 57
S. 57 E. 29	24 60 00	NW	2 20 57
S. 58 NW	25 60 00	NW	2 20 57
S. 59 E. 30	26 60 00	NW	2 20 57
S. 60 NW	27 60 00	NW	2 20 57
S. 61 E. 31	28 60 00	NW	2 20 57
S. 62 NW	29 60 00	NW	2 20 57
S. 63 E. 32	30 60 00	NW	2 20 57
S. 64 NW	31 60 00	NW	2 20 57
S. 65 E. 33	32 60 00	NW	2 20 57
S. 66 NW	33 60 00	NW	2 20 57
S. 67 E. 34	34 60 00	NW	2 20 57
S. 68 NW	35 60 00	NW	2 20 57
S. 69 E. 35	36 60 00	NW	2 20 57
S. 70 NW	37 60 00	NW	2 20 57
S. 71 E. 36	38 60 00	NW	2 20 57
S. 72 NW	39 60 00	NW	2 20 57
S. 73 E. 37	40 60 00	NW	2 20 57
S. 74 NW	41 60 00	NW	2 20 57
S. 75 E. 38	42 60 00	NW	2 20 57
S. 76 NW	43 60 00	NW	2 20 57
S. 77 E. 39	44 60 00	NW	2 20 57
S. 78 NW	45 60 00	NW	2 20 57
S. 79 E. 40	46 60 00	NW	2 20 57
S. 80 NW	47 60 00	NW	2 20 57
S. 81 E. 41	48 60 00	NW	2 20 57
S. 82 NW	49 60 00	NW	2 20 57
S. 83 E. 42	50 60 00	NW	2 20 57
S. 84 NW	51 60 00	NW	2 20 57
S. 85 E. 43	52 60 00	NW	2 20 57
S. 86 NW	53 60 00	NW	2 20 57
S. 87 E. 44	54 60 00	NW	2 20 57
S. 88 NW	55 60 00	NW	2 20 57
S. 89 E. 45	56 60 00	NW	2 20 57
S. 90 NW	57 60 00	NW	2 20 57
S. 91 E. 46	58 60 00	NW	2 20 57
S. 92 NW	59 60 00	NW	2 20 57
S. 93 E. 47	60 60 00	NW	2 20 57
S. 94 NW	61 60 00	NW	2 20 57
S. 95 E. 48	62 60 00	NW	2 20 57
S. 96 NW	63 60 00	NW	2 20 57
S. 97 E. 49	64 60 00	NW	2 20 57
S. 98 NW	65 60 00	NW	2 20 57
S. 99 E. 50	66 60 00	NW	2 20 57
S. 100 NW	67 60 00	NW	2 20 57

3-36

TOWNSHIP 4 SOUTH, RANGE 6 WEST OF THE MICHIGAN MERIDIAN, MICHIGAN  
SURVEY OF TWO ISLANDS IN NOTTAWA LAKE SECTION 3

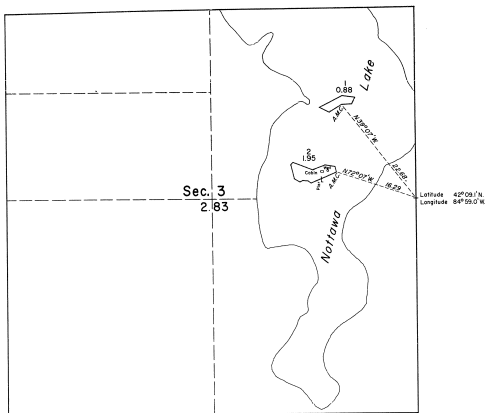

This plat represents the survey of an island in Nottawa Lake not previously surveyed or included within the areas as shown on the plat dated March 31, 1886.

This survey was executed by James F. Scott, Cadastral Surveyor, beginning October 7, 1965, and completed October 31, 1965, pursuant to Special Instructions for Group No. 75, Michigan, dated September 26, 1965.

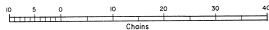

UNITED STATES DEPARTMENT OF THE INTERIOR  
BUREAU OF LAND MANAGEMENT  
Washington, D. C.      May 12, 1967

This plat is strictly conformable to the approved field notes, and the survey, having been correctly executed in accordance with the requirements of law and the regulations of this Bureau, is hereby accepted.

For the Director

Chief, Division of Engineering