

Township N. VI south. Range N. XIV west. (Mic. Ter.)

2-27

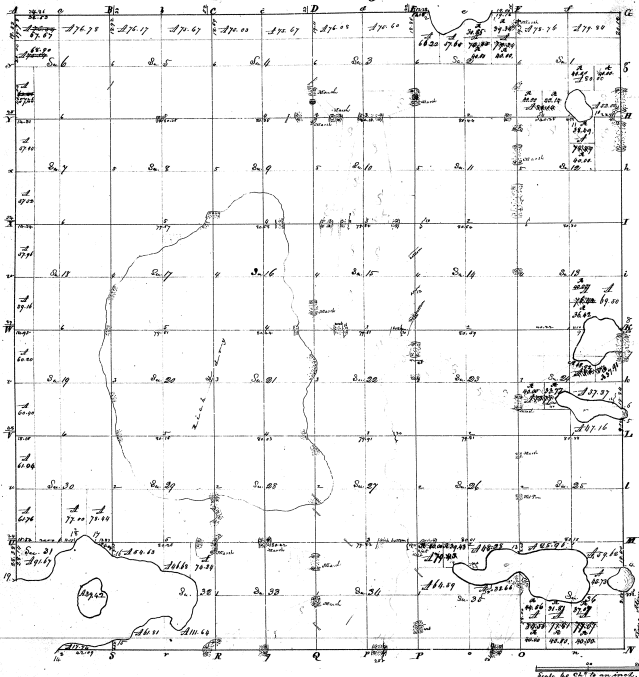

Completed

Surveyed in July 1888 by Calvin Bodman & Son

Frontage			Backage		
Section	Area	Vol.	Section	Area	Vol.
1	71 50	1	41	600	
2	50	2	42	600	
3	71 71	3	43	600	
4	50	4	44	600	
5	50	5	45	160	
6	50	6	46	56	50
7	50	7	47	58	50
8	50	8	48	58	50
9	50	9	49	58	50
10	50	10	50	58	50
11	50	11	51	58	50
12	50	12	52	58	50
13	50	13	53	58	50
14	50	14	54	58	50
15	50	15	55	58	50
16	50	16	56	58	50
17	50	17	57	58	50
18	50	18	58	58	50
19	50	19	59	58	50
20	50	20	60	58	50
21	50	21	61	58	50
22	50	22	62	58	50
23	50	23	63	58	50
24	50	24	64	58	50
25	50	25	65	58	50
26	50	26	66	58	50
27	50	27	67	58	50
28	50	28	68	58	50
29	50	29	69	58	50
30	50	30	70	58	50
31	50	31	71	58	50
32	50	32	72	58	50
33	50	33	73	58	50
34	50	34	74	58	50
35	50	35	75	58	50
36	50	36	76	58	50
37	50	37	77	58	50
38	50	38	78	58	50
39	50	39	79	58	50
40	50	40	80	58	50
41	50	41	81	58	50
42	50	42	82	58	50
43	50	43	83	58	50
44	50	44	84	58	50
45	50	45	85	58	50
46	50	46	86	58	50
47	50	47	87	58	50
48	50	48	88	58	50
49	50	49	89	58	50
50	50	50	90	58	50
51	50	51	91	58	50
52	50	52	92	58	50
53	50	53	93	58	50
54	50	54	94	58	50
55	50	55	95	58	50
56	50	56	96	58	50
57	50	57	97	58	50
58	50	58	98	58	50
59	50	59	99	58	50
60	50	60	100	58	50
61	50	61	101	58	50
62	50	62	102	58	50
63	50	63	103	58	50
64	50	64	104	58	50
65	50	65	105	58	50
66	50	66	106	58	50
67	50	67	107	58	50
68	50	68	108	58	50
69	50	69	109	58	50
70	50	70	110	58	50
71	50	71	111	58	50
72	50	72	112	58	50
73	50	73	113	58	50
74	50	74	114	58	50
75	50	75	115	58	50
76	50	76	116	58	50
77	50	77	117	58	50
78	50	78	118	58	50
79	50	79	119	58	50
80	50	80	120	58	50
81	50	81	121	58	50
82	50	82	122	58	50
83	50	83	123	58	50
84	50	84	124	58	50
85	50	85	125	58	50
86	50	86	126	58	50
87	50	87	127	58	50
88	50	88	128	58	50
89	50	89	129	58	50
90	50	90	130	58	50
91	50	91	131	58	50
92	50	92	132	58	50
93	50	93	133	58	50
94	50	94	134	58	50
95	50	95	135	58	50
96	50	96	136	58	50
97	50	97	137	58	50
98	50	98	138	58	50
99	50	99	139	58	50
100	50	100	140	58	50
101	50	101	141	58	50
102	50	102	142	58	50
103	50	103	143	58	50
104	50	104	144	58	50
105	50	105	145	58	50
106	50	106	146	58	50
107	50	107	147	58	50
108	50	108	148	58	50
109	50	109	149	58	50
110	50	110	150	58	50
111	50	111	151	58	50
112	50	112	152	58	50
113	50	113	153	58	50
114	50	114	154	58	50
115	50	115	155	58	50
116	50	116	156	58	50
117	50	117	157	58	50
118	50	118	158	58	50
119	50	119	159	58	50
120	50	120	160	58	50
121	50	121	161	58	50
122	50	122	162	58	50
123	50	123	163	58	50
124	50	124	164	58	50
125	50	125	165	58	50
126	50	126	166	58	50
127	50	127	167	58	50
128	50	128	168	58	50
129	50	129	169	58	50
130	50	130	170	58	50
131	50	131	171	58	50
132	50	132	172	58	50
133	50	133	173	58	50
134	50	134	174	58	50
135	50	135	175	58	50
136	50	136	176	58	50
137	50	137	177	58	50
138	50	138	178	58	50
139	50	139	179	58	50
140	50	140	180	58	50
141	50	141	181	58	50
142	50	142	182	58	50
143	50	143	183	58	50
144	50	144	184	58	50
145	50	145	185	58	50
146	50	146	186	58	50
147	50	147	187	58	50
148	50	148	188	58	50
149	50	149	189	58	50
150	50	150	190	58	50
151	50	151	191	58	50
152	50	152	192	58	50
153	50	153	193	58	50
154	50	154	194	58	50
155	50	155	195	58	50
156	50	156	196	58	50
157	50	157	197	58	50
158	50	158	198	58	50
159	50	159	199	58	50
160	50	160	200	58	50

2-8

ORIGINAL

27-27

TOWNSHIP 6 SOUTH, RANGE 14 WEST, OF THE MICHIGAN MERIDIAN, MICHIGAN.  
PLAT OF AN ISLAND

The island designated as Tract 27, Township 6 South, Range 14 West, Michigan meridian, hereinafter, on this plat represents land above the ordinary high water mark of Howell Lake.

The description of this island was prepared from U.S. Geological Survey hydrographic and "Soundings, 1882", volume of 1882, and astronomical observations. The same was established with a great accuracy by an authorized man.

Tract 27, County Register District No. 11, is five feet 20 1/2 inches the ordinary high water mark. The soil is all loam, between 1 to 2 1/2 feet. The surface consists of maple, elm, apple, oak, and willow, with a surface 200 ft. 1800 acres.

The ground water level of the lake connects favorably with that of the adjacent member lake; therefore, the ordinary and ordinary water level of the island being with height and width of the ordinary water level in 1877, the year 1877, was submitted into the State. The original survey of 1877 for the purpose of the island in the field was made of the members of Howell Lake.

The island referred to this plat is situated on the lake more than 100 acres, and is situated within the jurisdiction of the State and Federal Act of September 26, 1850 (10 Stat. 437).

Bound, as indicated herein, the platings and areas are as shown on the plat approved December 11, 1900.

This plat was prepared in accordance with Special Instructions for Tract 27, Michigan, dated May 20, 1881, to accommodate the transfer of title under the authority of Section 217 of 22 Stat. 100 U.S.C. (1881) - (see Statutes Michigan State Register 2, 1881).

UNITED STATES DEPARTMENT OF THE INTERIOR  
BUREAU OF LAND MANAGEMENT  
Alameda, Virginia

June 3, 1900

This plat, having been correctly prepared in accordance with the requirements of law and the regulations of this Bureau, is hereby approved.

For the Register

*Charles E. Brown*  
Chief Cataloger Surveyor  
Eastern Maine Office

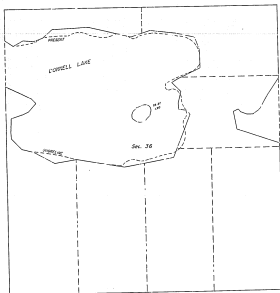

This plat certifies the  
actual measure of Tract 27.