

Township 1° 32' N. Range 1° 5' W. Mer. Mich.

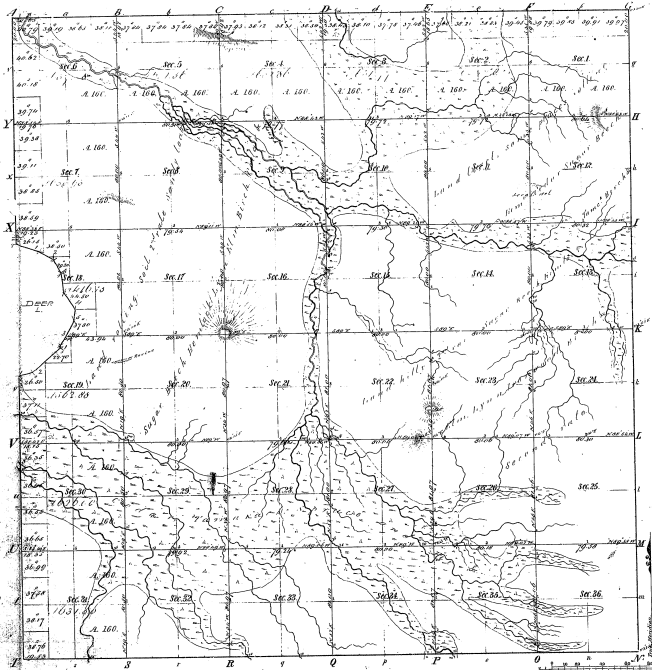

Boundaries of

Public Course 1848

Private Courses 1848

Public Course 1862

Private Courses 1862

Public Course 1862

Private Courses 1862

Public Course 1862

Private Courses 1862

Public Course 1862

Private Courses 1862

Public Course 1862

Private Courses 1862

Public Course 1862

Private Courses 1862

Public Course 1862

Private Courses 1862

Public Course 1862

Private Courses 1862

Public Course 1862

Private Courses 1862

Public Course 1862

Private Courses 1862

Public Course 1862

Private Courses 1862

Public Course 1862

Private Courses 1862

Public Course 1862

Private Courses 1862

Public Course 1862

Private Courses 1862

Public Course 1862

Private Courses 1862

Public Course 1862

Private Courses 1862

Public Course 1862

Private Courses 1862

Public Course 1862

Private Courses 1862

Public Course 1862

Private Courses 1862

Public Course 1862

Private Courses 1862

Public Course 1862

Private Courses 1862

Public Course 1862

Private Courses 1862

Public Course 1862

Private Courses 1862

Public Course 1862

Private Courses 1862

Public Course 1862

Private Courses 1862

Public Course 1862

Private Courses 1862

Public Course 1862

Private Courses 1862

Public Course 1862

Private Courses 1862

Public Course 1862

Private Courses 1862

Public Course 1862

Private Courses 1862

Public Course 1862

Private Courses 1862

Public Course 1862

Private Courses 1862

Total number of Acres 22670.36

| Township designated | By whom | date | of Contract | Amount of Survey | When Surveyed | Whom by and at the Station |
|---------------------|---------------|---------------|-------------|------------------|---------------|----------------------------|
| Township 1° 32' N. | John H. Smith | Jan 25 1860 | | 4 | 28 49 | at Course 1862 |
| Subdivisions | William Smith | April 20 1860 | | 81 | 22 32 | at Course 1860 |

The above Map of Township 1° 32' North of Range 1° 5' West of the Principal Meridian Michigan is a stretch conformable to the field notes of the survey thereof filed in the office which have been examined and approved
 Surveyor General's Office
 Detroit Jan 22 1860
 Charles Noble Surveyor

18
25

18-25