

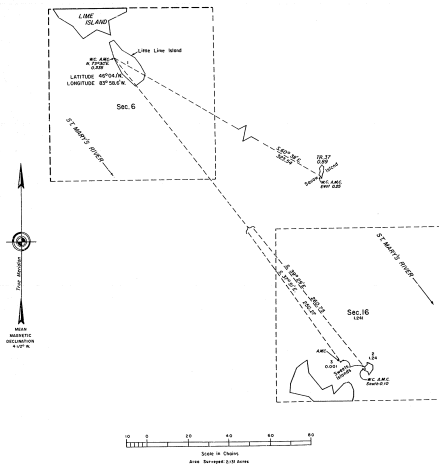

TOWNSHIP 42 NORTH, RANGE 4 EAST, MICHIGAN MERIDIAN, MICHIGAN.  
SURVEY OF ISLANDS

33-23



A history of surveys is contained in the field notes.

This plat represents the survey of three islands in St. Marys River, T. 42 N., R. 4 E., Michigan Meridian, Michigan.

Except as indicated hereon, the findings and areas are as shown on the plat approved January 31, 1884, and the plat accepted August 4, 1899.

Except as indicated hereon, the findings and areas are as shown on the plat approved January 31, 1884, and the plat accepted August 4, 1899.

Survey conducted by Gary L. Davis, Cadastral Surveyor, beginning August 3, 1977, and completed August 5, 1977, pursuant to Special Instructions dated June 3, 1977, for Group No. 74, Michigan.

UNITED STATES DEPARTMENT OF THE INTERIOR  
BUREAU OF LAND MANAGEMENT  
November 19, 1981  
Denver, Colorado

This plan is hereby conformable to the approved field notes, and the survey, having been correctly conducted in accordance with the requirements of law and the regulations of this Bureau, is hereby accepted.

For the Director

*James D. Whit*

Acting Chief, Cadastral Survey  
Examination and Approval Staff

16

16

17

17

16

16

TOWNSHIP 42 NORTH, RANGE 4 EAST, MICHIGAN MERIDIAN, MICHIGAN  
SURVEY OF ISLAND IN SECTION 6

33-23 (2)

Field Notes of Survey

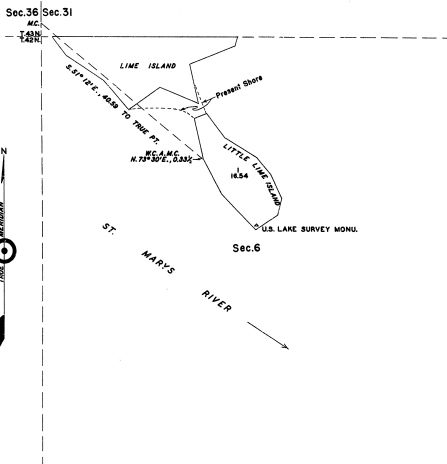

Surveys as represented hereon were executed with a Corley solar transit, constructed in accordance with Bureau of Land Management specifications, which transit was in good condition and was placed in satisfactory adjustment prior to undertaking this work. Direction of all lines refer to true meridian and were determined by the solar transit method or by prolongation of celestial observations. Distances are expressed in chains, measured on the slope, reduced to horizontal equivalents.

The meander cor. of secs. 31, 32, 33, 34, 35, 36, 37, 38, 39, 40, 41, 42, 43, 44, 45, 46, 47, 48, 49, 50, on the south shore of Lime Island, was reestablished in 1897; it is monumented with a regulation iron post, set, mhd. and witness as described in the official record.

Thence, S. 51° 12' E., 40.29 chs. to point for auxiliary meander cor. on little Line Island in sec. 6, T. 42 N., R. 4 E., at mean high water line of St. Marys River; connection made by traverse of shore.

Point for A&C falls in an impractical position for monument which would be subject to destruction by high waters and ice.

Therefore, at a point N. 75° 30' E., 33 1/2 chs. dist.

Set a regulation iron post, 2 1/2 ins. diam., 16 ins. in ground and rounded to top with stone, for witness cor., with brass cap mhd.

W C  
A & C  
T 42 N R 4 E  
S 6  
1898

from which

A cedar, 5 ins. diam., bears S. 4° W., 9 lks. dist., mhd. W C A&C 55 ST.  
A birch, 10 ins. diam., bears N. 20° E., 9 lks. dist., mhd. W C A&C 55 ST.

The meander cor. of secs. 31 and 36, T. 42 N., R. 3 and 4 E., bears N. 51° 35' W., 40.79 chs. dist.

Thence from the true point for the A&C, meander Little Line Island, at the mean high water line of St. Marys River, along a well-defined, sloping and rocky shore; timber and undergrowth to the left.

S. 28° 45' E.,	7.40 chs.	N. 38° 25' W.,	5.98 chs.	Midpoint on the connecting bar bet. Lime I. and Little Line I;
S. 44° 45' E.,	7.40 chs.	From end of rocky		thence across bar on line normal to shore.
N. 57° 00' E.,	5.00 chs.	N. 66° 00' W.,	2.08 chs.	Midpoint on SW. side of bar; thence resume meandering the above line.
N. 14° 00' E.,	3.10 chs.			
N. 25° 15' W.,	5.00 chs.			
N. 40° 45' W.,	4.10 chs.			
N. 58° 15' W.,	7.00 chs.	S. 14° 25' E.,	7.70 chs.	The A&C and point of beginning.

General Description

Little Line Island is of a black organic loam over a base stony formation, reaching approximately 16 feet above the mean water level of St. Marys River.

The timber species consists of spruce, cedar, birch, poplar, balsam of Gilead and white pine, ranging in size from 4 to 12 ins. diam.; the undergrowth is dense young timber, with some alder.

There are no improvements on the island.

The island was noted in the original surveys of Lime Island, separate and distinct therefrom, but was not included in these surveys. Since that time the island has been connected with Lime Island by a sandy spit about 3 chs. wide and 2 ft. high, which bar is covered with grasses and reeds but does not support any timber. This survey includes that portion of the bar situated southeasterly of the medial line between the original limits of the two islands as could best be determined, using the considered description or relation bearing to Little Line I. There was no evidence of any last channel between the two islands. The rocky formation and timber growth thereon attests to the fact that Little Line I. was in existence in 1837, when Michigan was admitted into the Union, and is evidence of its continuous existence since those dates. It is further noted in the original surveys of 1845. The island therefore has the status of public land.

The island is 100% upland.

UNITED STATES DEPARTMENT OF THE INTERIOR  
BUREAU OF LAND MANAGEMENT  
Washington, D. C., August 4, 1999

This plat is strictly conformable to the above field notes of survey, which have been critically examined and found correct, and are hereby approved, and the survey, having been properly executed in accordance with the requirements of law and the regulations of this Bureau, is hereby accepted.

For the Director  
*Carl P. Starnett*  
Cadastral Engineering Staff Officer

I HEREBY CERTIFY UPON HONOR that, in pursuance of Special Instructions for Group 07, Michigan, bearing date of August 5, 1996, and Assignment Instructions dated August 5, 1998, I surveyed on September 3, 1998, Little Line Island in St. Marys River, sec. 6, Tp. 42 N., R. 4 E., Michigan Meridian, in the State of Michigan, which is represented by this diagram and field notes of survey, and that said survey has been made in strict conformity with said instructions, the Manual of Instructions for Survey of the Public Lands of the United States, and in the specific manner described in the notes of survey.

*Hugh B. Crawford*

Hugh B. Crawford  
Cadastral Surveyor

June 18, 1999.

RLS

This plat represents the complete record of survey.