

**Township N<sup>o</sup> 45 N. Range N<sup>o</sup> 2 W Mer. Mich.**

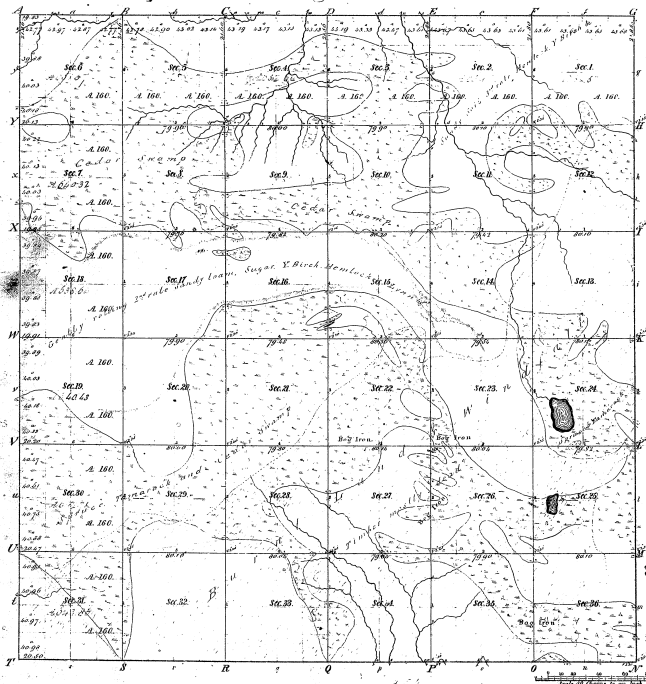

Mileage of			
Post Courses	1849	Post Courses	1849

54-26

54-26

Total number of Acres 124.54			
Surveys Designated	By Whom Surveyed	Date of Contract	Amount of Survey

The above Map of Township N 45 North of Range N 2 West of the  
 Principal Meridian Michigan is  
 in, and is, hereby responsible to the field notes  
 of the survey thereon on file in the Office, which have been examined and approved.  
 Surveyor General's Office Charles Arden Surveyor General  
 Detroit Michigan 12 1852