

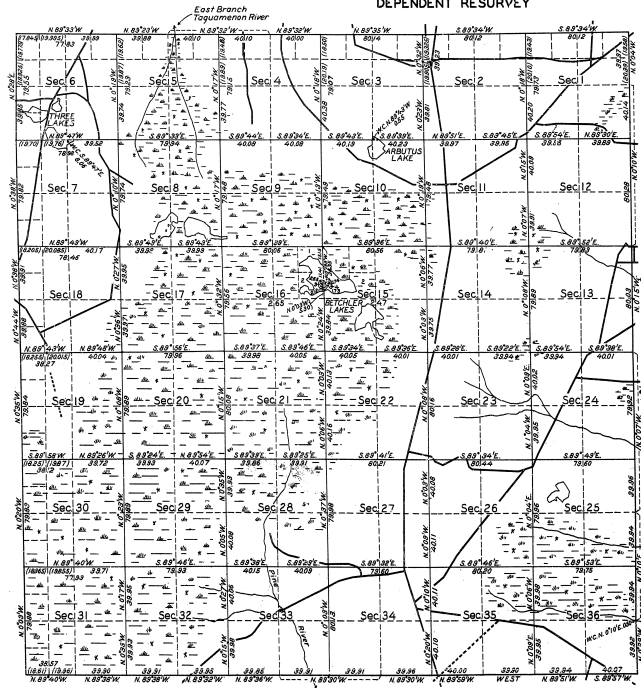

TOWNSHIP NO. 45 NORTH, RANGE NO. 5 WEST, MICHIGAN MERIDIAN, MICHIGAN

DEPENDENT RESURVEY

34-23  
 ②  
 34-23



MEMORANDUM  
 THIS PLAT OF THE RESURVEY OF TOWNSHIP 45 NORTH, RANGE 5 WEST, DELINEATES A RETRACEMENT AND REESTABLISHMENT OF THE LINES OF THE ORIGINAL SURVEY AS SHOWN UPON THE PLAT APPROVED JUNE 6, 1891, IN THEIR TRUE ORIGINAL POSITIONS ACCORDING TO THE BEST AVAILABLE EVIDENCE OF THE ORIGINAL CORNERS. ALL DIFFERENCES BETWEEN THE MEASUREMENTS SHOWN ON THE ORIGINAL PLAT AND THOSE DERIVED IN THE RETRACEMENT HAVE BEEN DISTRIBUTED PROPORTIONALLY BETWEEN ACCEPTED CORNERS IN ACCORDANCE WITH SURVEYING RULES. REFERENCE WILL BE MADE TO THE ORIGINAL PLAT FOR THE SHOWING OF AREAS OF THE VARIOUS SUBDIVISIONS.

THIS PLAT ALSO REPRESENTS THE SURVEY OF TWO ISLANDS IN A MEANDERED LAKE WITHIN THE TOWNSHIP, WHICH WERE NOT INCLUDED IN THE ORIGINAL SURVEY AS SHOWN UPON THE OFFICIAL PLAT.

AUTHORITY FOR THE RESURVEY OF THE TOWNSHIP IS CONTAINED IN GENERAL LAND OFFICE LETTER, BUREAU NO. 43 DATED MARCH 16, 1931, WHICH BEARS DEPARTMENTAL APPROVAL UNDER DATE OF MARCH 2, 1931. THE ISLAND SURVEYS WERE AUTHORIZED BY LETTERS DATED SEPTEMBER 10, 1932, WHICH BEARS DEPARTMENTAL APPROVAL UNDER THE SAME DATE.

THE TOWNSHIP HAS EXTENSIVE AREAS OF OPEN MUSKIEB MARSH AND SPRUCE, TAMARACK AND CEDAR SWAMPS. THE UPLAND HAS A SCATTERING GROWTH OF SMALL TIMBER CONSISTING MAINLY OF JACK PINE AND POPLAR.

OFFICE OF U. S. SUPERVISOR OF SURVEYS,  
 DENVER, COLORADO, JULY 1, 1935

THE ABOVE PLAT OF TOWNSHIP NO. 45 NORTH, RANGE NO. 5 WEST OF THE MICHIGAN MERIDIAN, IN THE STATE OF MICHIGAN, IS STRICTLY CONFORMABLE TO THE FIELD NOTES OF THE RESURVEY THEREOF, WHICH HAVE BEEN EXAMINED AND APPROVED.

*Wm. H. Armon*

U. S. SUPERVISOR OF SURVEYS.

DEPARTMENT OF THE INTERIOR,  
 GENERAL LAND OFFICE.

WASHINGTON, D. C., FEBRUARY 27, 1936.

THE SURVEY REPRESENTED BY THIS PLAT, HAVING BEEN CORRECTLY EXECUTED IN ACCORDANCE WITH THE REQUIREMENTS OF LAW AND THE REGULATIONS OF THIS OFFICE, IS HEREBY ACCEPTED.

*Carlton L. Leland*  
 ASSISTANT COMMISSIONER.

SCALE: 40 CHAINS TO AN INCH. AREA SURVEYED: 22,867.65 ACRES. AREA SURVEYED: 5.12 ACRES.

LINES DESIGNATED	BY WHOM SURVEYED	GROUP NO.	DATE	MILEAGE		WHEN SURVEYED	
				MLB.	CHS.	BEGUN	COMPLETED
EXTERIOR	OFF. R. VEAL		JUNE 6,	83	74.97	JULY 09,	007. 6,
SUBDIVISIONAL	U. S. CADASTRAL	31	1932,	59	65.54	1932.	1932.
MEANDERS			REF. 1,	8	34.68		
CONNECTIONS	ENGINEER.		1932.		4.00		