

Re-survey and correction of  
 Township 15<sup>th</sup> N Range 3<sup>rd</sup> W Mer. Michigan

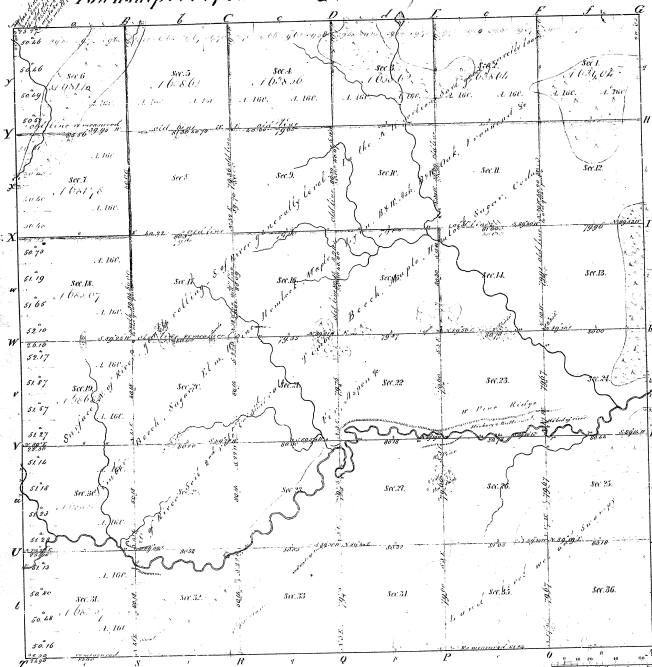

Standard or  
 Public Course 1814<sup>th</sup> Public Course 1814<sup>th</sup> Public Course 1814<sup>th</sup>

137  
 Note The lines shaded red have been examined  
 as corrected.  
 The lines shaded purple are the line of the  
 old survey which runs the original line  
 and the remainder of the township has  
 been resurveyed.  
 The distance is set out as correct from the drawings

13-14

		Trial number of acres			
Survey completed	By whom surveyed	Date or Year	Amount of acres	When surveyed	When set out and as the Surveyor's
Township Survey	John Anthony	June 18, 1857	11,485 1/2	1857	1857
Subdivisions	John Anthony	July 21, 1857	36,20,32	1857	1857
Re-surveyed	John Anthony	1857	36,20,32	1857	1857
Re-surveyed	John Anthony	1857	36,20,32	1857	1857
Re-surveyed	John Anthony	1857	36,20,32	1857	1857

Showing the resurvey measurements & correction  
 the above map in Township 15<sup>th</sup> North of Range 3<sup>rd</sup> West of the  
 Principal Meridian. The resurvey is hereby approved and approved  
 of the survey being in full accordance with the laws and approved  
 Surveyor General's Office  
 E. C. Cook Sept. 11, 1857  
 Charles F. Brown  
 Surveyor General