

Township N.º 17 N., Range N.º 3 West Mer. (Mich.)

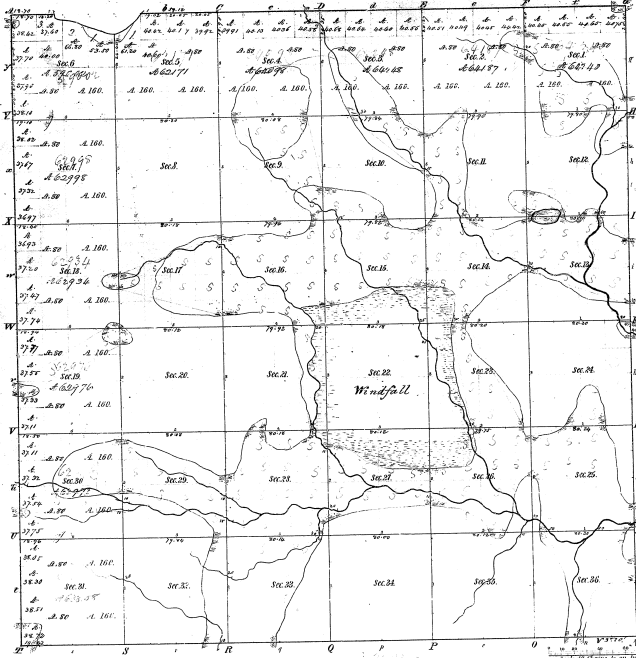

Meanders of a Lake in Sections 3 & 6

Point	Course	Dist	Point	Course	Dist	Course	Dist
1.	S 77° 16' 0"	1.00					
2.	S 77° 16' 0"	1.00					
3.	S 77° 16' 0"	1.00					
4.	S 77° 16' 0"	1.00					
5.	S 77° 16' 0"	1.00					
6.	S 77° 16' 0"	1.00					
7.	S 77° 16' 0"	1.00					
8.	S 77° 16' 0"	1.00					
9.	S 77° 16' 0"	1.00					
10.	S 77° 16' 0"	1.00					
11.	S 77° 16' 0"	1.00					
12.	S 77° 16' 0"	1.00					
13.	S 77° 16' 0"	1.00					
14.	S 77° 16' 0"	1.00					
15.	S 77° 16' 0"	1.00					
16.	S 77° 16' 0"	1.00					
17.	S 77° 16' 0"	1.00					
18.	S 77° 16' 0"	1.00					
19.	S 77° 16' 0"	1.00					
20.	S 77° 16' 0"	1.00					
21.	S 77° 16' 0"	1.00					
22.	S 77° 16' 0"	1.00					
23.	S 77° 16' 0"	1.00					
24.	S 77° 16' 0"	1.00					
25.	S 77° 16' 0"	1.00					
26.	S 77° 16' 0"	1.00					
27.	S 77° 16' 0"	1.00					
28.	S 77° 16' 0"	1.00					
29.	S 77° 16' 0"	1.00					
30.	S 77° 16' 0"	1.00					
31.	S 77° 16' 0"	1.00					
32.	S 77° 16' 0"	1.00					
33.	S 77° 16' 0"	1.00					
34.	S 77° 16' 0"	1.00					
35.	S 77° 16' 0"	1.00					
36.	S 77° 16' 0"	1.00					

12-13
18-7

Total number of Acres. 62 9/16

Survey Designated	By Whom Surveyed	Date of Contract	Amount of Survey	When Surveyed
Township	John B. ...	July 21, 1837	62 9/16	1837
Subdivisions	John B. ...	July 21, 1837	62 9/16	1837

The above copy of Township, 17 N. 3 W. of Range 125 East of the Principal Meridian, Michigan, is strictly conformable to the field notes of the survey thereon on file in this office which have been examined and approved.

Surveyor General's Office
Ann Arbor, Mich. 11/29

W. C. ...