

Township N<sup>o</sup> 42 N. Range N<sup>o</sup> 21 W. Mer. Mich.

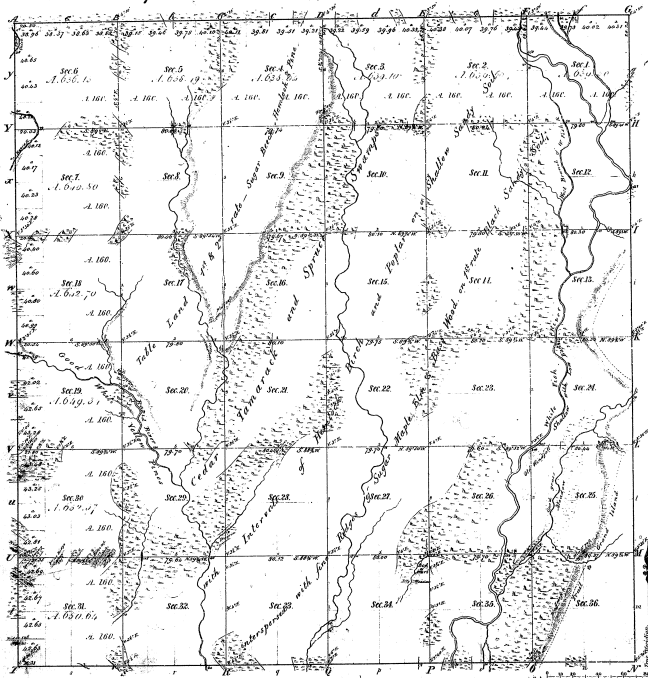

Boundaries of  
Township N42 N, Range N21 W, Mer. Mich.

31.30

37-35

Total number of Acres 23007.57

Survey Designated	By Whom Surveyed	Date of Contract	Amount of Survey	When Surveyed	Area in Acres
Donorship lines	John J. West	July 24, 1842	72.25	72	28.25
Subdivisions	A. Thompson	July 11, 1846	62.22	34 <sup>th</sup>	23.68

The above map of Township N42 North of Range N21 West of the Principal Meridian Michigan is a true and correct copy of the survey thereof on file in this Office, which have been examined and approved.  
Surveyor General's Office  
Detroit April 10, 1848  
Lucius Lyon, Surveyor