

Township N. 34 Range W. 6 Mer.

LAKE MICHELETT

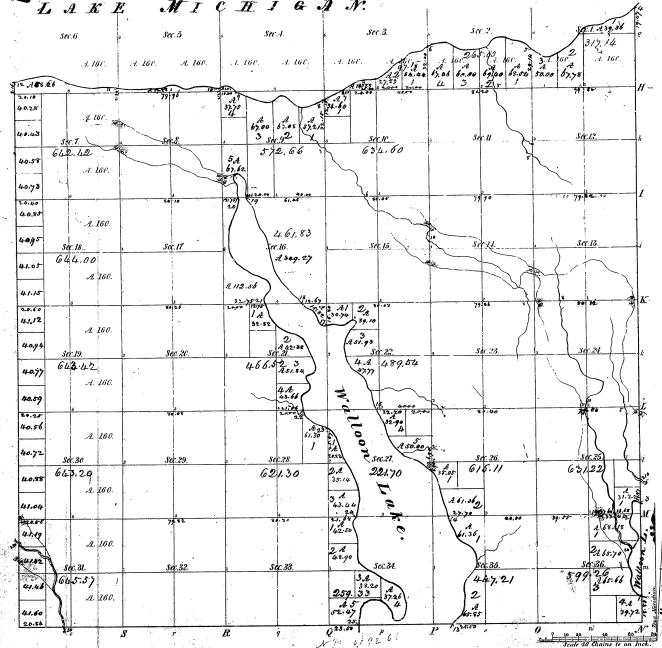

Number of Sects.	Area	Section	Area	Section	Area	Section	Area
1	360.00	1	360.00	17	360.00	17	360.00
2	360.00	2	360.00	18	360.00	18	360.00
3	360.00	3	360.00	19	360.00	19	360.00
4	360.00	4	360.00	20	360.00	20	360.00
5	360.00	5	360.00	21	360.00	21	360.00
6	360.00	6	360.00	22	360.00	22	360.00
7	360.00	7	360.00	23	360.00	23	360.00
8	360.00	8	360.00	24	360.00	24	360.00
9	360.00	9	360.00	25	360.00	25	360.00
10	360.00	10	360.00	26	360.00	26	360.00
11	360.00	11	360.00	27	360.00	27	360.00
12	360.00	12	360.00	28	360.00	28	360.00
13	360.00	13	360.00	29	360.00	29	360.00
14	360.00	14	360.00	30	360.00	30	360.00
15	360.00	15	360.00	31	360.00	31	360.00
16	360.00	16	360.00	32	360.00	32	360.00
17	360.00	17	360.00	33	360.00	33	360.00
18	360.00	18	360.00	34	360.00	34	360.00
19	360.00	19	360.00	35	360.00	35	360.00
20	360.00	20	360.00	36	360.00	36	360.00

18-9

Survey Designated	By Whom Surveyed	Date of Condit	Amount of Survey	When Surveyed	When Surveyed
Township	John A. McArthur	1860	360.00	1860	1860
Section					

The above map of Township N. 34 R. W. 6 Mer. of the County of Alameda, California, is a true and correct copy of the original map on file in the office, and has been examined and approved.

Surveyor General's Office
Sacramento, Dec. 21, 1860.

Geo. S. Cook