

Township N<sup>o</sup> 36 N Range N<sup>o</sup> 6 W Mer.

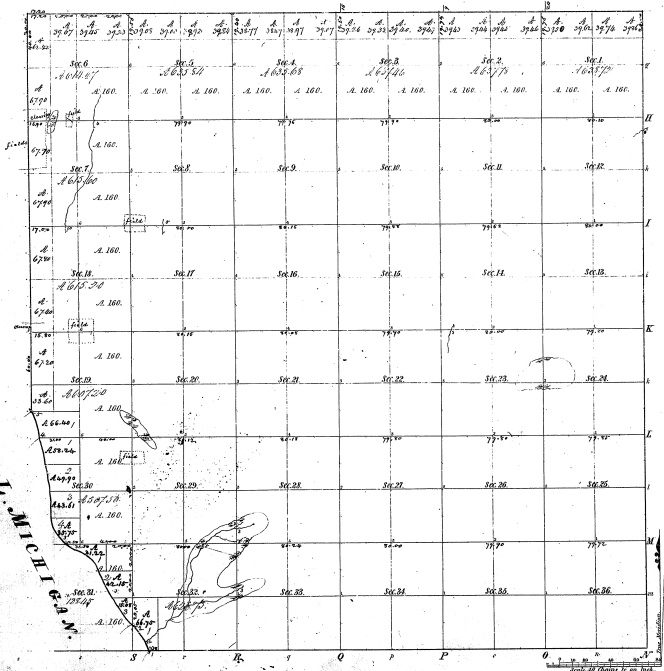

Numbers of Lots, Michigan

Sub	Course	Dist	Sub	Course	Dist	Sub	Course	Dist
1								
2								
3								
4								
5								

Total number of Acres 22,262.52

Survey designated	By Whom Surveyed	Date of Contract	Amount of Survey	When Surveyed	How far and what the Sec <sup>o</sup> was
Michigan State	L. Michels	Jan. 15, 1860	62.52	2 <sup>o</sup> - 22	1860
Subdivisions	Same	Apr. 11	61.82	25	1861

This plat is a copy of Township N<sup>o</sup> 36 N. of Range N<sup>o</sup> 6 W. of the Principal Meridian, Michigan, is a survey conformable to the field notes of the survey above on file in this office and has been examined and approved.

Surveyor General's Office  
Grand Rapids, Feb. 2, 1864

*C. Stearns* Surveyor General

19-24  
19-24