

Township N^o 43. N. Range N^o 38. W. Mer. Mich.

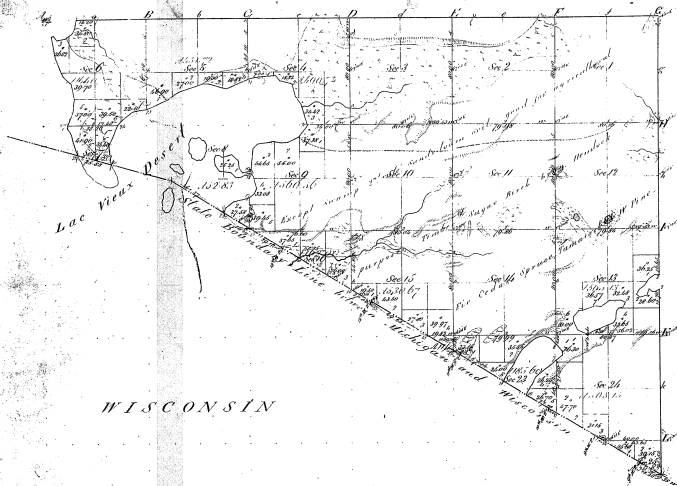

WISCONSIN

Boundaries of
Township N 43 N Range N 38 W Meridian Michigan

43-37

43-37

Total number of acres 8155.26

Surveyor's Name	Ap. Plan, Dated	Date of Order	Number of Acres	When Surveyed	Was changed to the Gov. Land Act?
Surveyor's Name	Ap. Plan, Dated	Date of Order	Acres	When Surveyed	Was changed to the Gov. Land Act?
W. R. S. Co.	April 15, 1857	April 15, 1857	31.25	1857	
W. R. S. Co.	April 15, 1857	April 15, 1857	21.25	1857	

The above Map of Township N 43 N Mer. of Range N 38 W Mer. of the
 Meridian of Michigan, is a correct and true copy of the
 original survey, and is on file in this office, and has been examined and approved.
 Surveyor General's Office
 Detroit, Apr. 25, 1857.

Charles Atter, Sur. Genl.

Rep. of Atter

PLAT OF AN ISLAND

in Lake Vieux Desert

in the south half of the northwest quarter of Sec. 8, T. 43 N., R. 38 W., Mich. Mer.,
MICHIGAN.

Surveyed by A.A. Babcock, Jr., U.S. Deputy Surveyor, April 9-July 21, 1908,
under special instructions from the Com^r G.L.O., bearing date May 7, 1908.

Scale, 40 chs. to an inch.

43-37

43-37-3

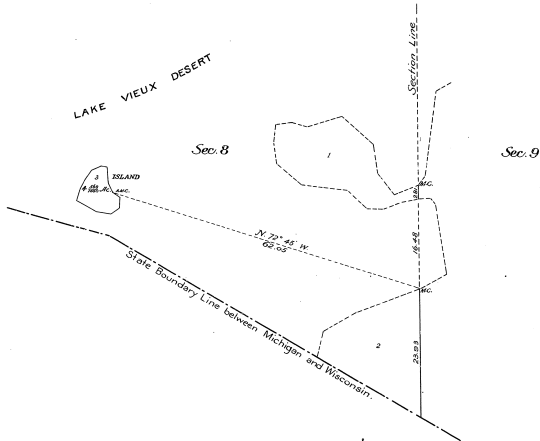

Department of the Interior,
General Land Office,
Washington, D.C., March 23, 1909.

The above plat of an Island in Lake Vieux Desert, in the south half of the northwest quarter of Sec. 8, T. 43 N., R. 38 W., Mich. Mer., Michigan, is a correct plat of a survey executed by A.A. Babcock, Jr., U.S. Deputy Surveyor, in pursuance of special instructions from the Commissioner of the General Land Office, bearing date May 7, 1908, and is strictly conformable to the field notes of the survey thereof on file in this office which have been examined and approved.

Acting *S. H. Rowlett*
Commissioner and Ex-officio
U.S. Surveyor General for Michigan.

PLAT OF AN ISLAND

in
LAKE VIEUX DESERT

in the west half of the northeast quarter, and the east half of the northwest quarter of Section 8,
T. 43 N., R. 38 W., MICH. MER., MICHIGAN.

Surveyed by Charles M. Pidgeon, U.S. Deputy Surveyor, July 19 to 21, 1911,
under instructions from the Com' G.L.O. bearing date June 19, 1911.

Scale 10 Chains to an Inch.

43-37

LE-CH

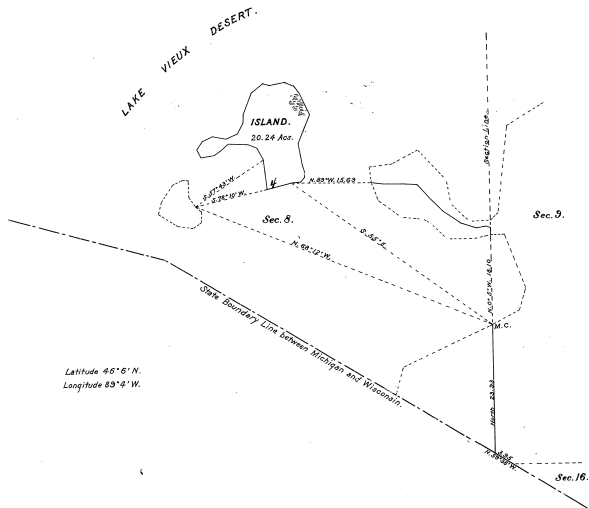

Latitude 46° 6' N.
Longitude 83° 4' W.

30.00

Department of the Interior,
General Land Office,
Washington, D. C., December 5, 1911.

The above plat of an island in Lake Vieux Desert, in the west half of the northeast quarter and the east half of the northwest quarter of Section 8, T. 43 N., R. 38 W., Mich. Mer., Michigan, is a correct plat of a survey executed by Charles M. Pidgeon, U.S. Deputy Surveyor, in pursuance of instructions from the Commissioner of the General Land Office bearing date June 19, 1911, and is strictly conformable to the field notes of the survey thereof on file in this office which have been examined and approved.

John D. ...
Commissioner and ex-officio
U.S. Surveyor General for Michigan.