

Township 1° 45' N. Range 1° 38' W. Mer. Michigan

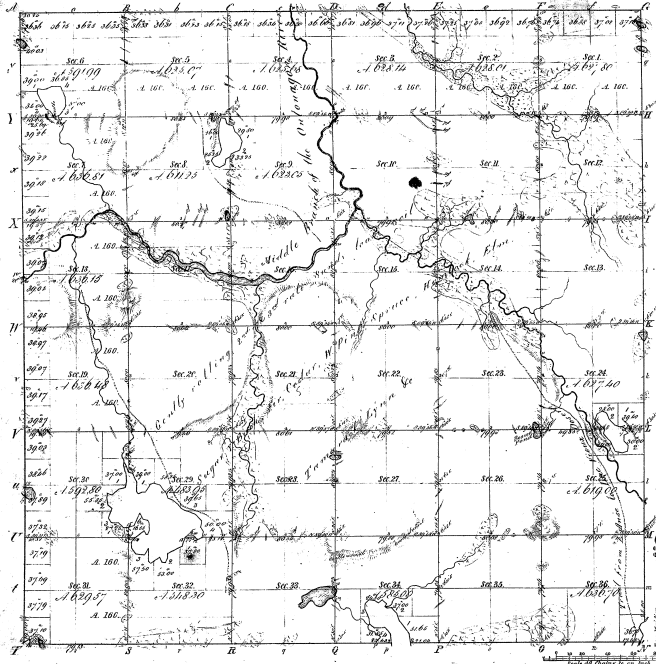

Minutes of
 First, Commrs. 1874. Paid, Commrs. 1875. Paid, Commrs. 1876.

113-25

43-25

Minutes:
 T. B. ...

Total number of Acres 22,473.14

Survey Designated	By Whom Surveyed	Date of Commencement	Amount of Survey	When Surveyed	Money Paid and in the Survey
Township, Range, Subdivisions	T. B. ...	April 27, 1851	4, 051 1/2	1851	...
	T. B. ...	April 16, 1851	67, 16 1/2	1851	...

The above Map of Township 1° 45' North of Range 1° 38' West of the Principal Meridian Michigan, is hereby conformable to the field notes of the survey thereof on file in this Office, which have been examined and approved.

Surveyor General of Michigan
 Detroit July 16, 1852

Thomas A. Hill
 Surveyor

TOWNSHIP NO. 45 NORTH, RANGE NO. 38 WEST, OF THE MICHIGAN MERIDIAN, MICHIGAN.
 PLAT OF AN ISLAND IN LAKE MARION, SEC. 32.

43-23
 43-25-2

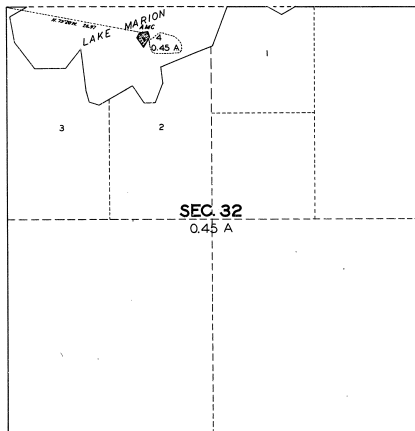

THIS PLAT REPRESENTS THE SURVEY OF AN ISLAND IN LAKE MARION IN SECTION 32, WHICH WAS NOT INCLUDED IN THE ORIGINAL SURVEY OF THE TOWNSHIP AS REPRESENTED ON THE PLAT APPROVED JULY 15, 1858. THE SURVEY WAS EXECUTED PURSUANT TO AUTHORITY CONTAINED IN GENERAL LAND OFFICE LETTER 1433308 "E", DATED MAY 3, 1932, WHICH BEARS DEPARTMENTAL APPROVAL UNDER DATE OF MAY 6, 1932.

OFFICE OF U.S. SUPERVISOR OF SURVEYS
 DENVER, COLORADO, DEC. 3, 1932

THE ABOVE PLAT OF AN ISLAND IN SECTION 32, TOWNSHIP NO. 45 NORTH, RANGE NO. 38 WEST, MICHIGAN MERIDIAN, MICHIGAN, IS STRICTLY CONFORMABLE TO THE FIELD NOTES OF THE SURVEY THEREOF WHICH HAVE BEEN EXAMINED AND APPROVED.

W. H. Thomas
 U.S. SUPERVISOR OF SURVEYS.

DEPARTMENT OF THE INTERIOR
 GENERAL LAND OFFICE
 WASHINGTON, D.C., DECEMBER 14, 1932.

THE SURVEY REPRESENTED BY THIS PLAT HAVING BEEN CORRECTLY EXECUTED IN ACCORDANCE WITH THE REQUIREMENTS OF LAW AND THE REGULATIONS OF THIS OFFICE, IS HEREBY ACCEPTED.

W. H. Thomas
 ASSISTANT COMMISSIONER.

SCALE: 10 CHAINS TO AN INCH.

AREA SURVEYED: 0.15 ACRES.

LINES DESIGNATED	BY WHOM SURVEYED	GROUP NO.	DATE	MILEAGE		WHEN SURVEYED	
				WLS.	CHS.	BEGUN	COMPLETED
CONNECTIONS	WESSON COOK, U.S. TRANSITMAN	32	JULY 13, 1932.	0	26.97	AUGUST 15, 1932.	AUGUST 15, 1932.
MEANDERS				0	8.47		