

17-3  
Township 1° 46' N. Range 3° 46' W. Mer. Michigan.

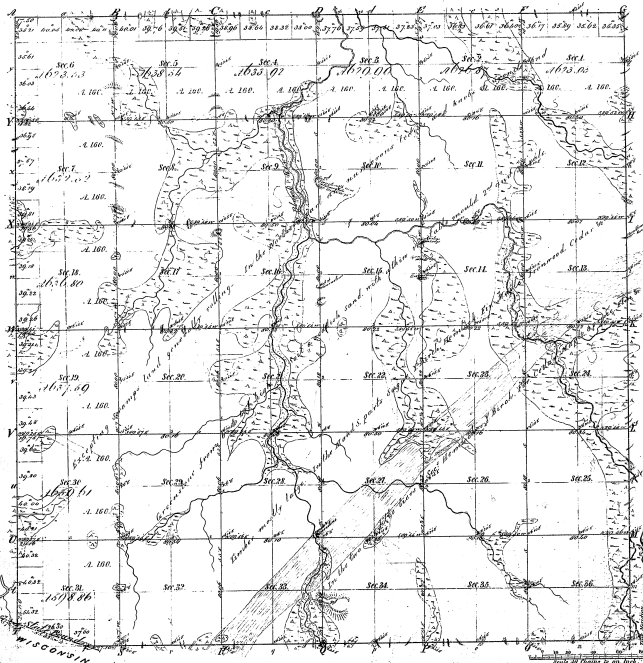

Total number of Acres 22021.36

Survey Designated	By Whom Surveyed	Date of Contract	Amount of Survey	When Surveyed	When Paid for and how the Sect. was sold
Township Base	John Black	April 27, 1837	36 28 1/2	1838	1838
Subdivisions	John Black	April 27, 1837	60 28 1/2	1838	1838
No. 6 Boundary	W. H. Black	April 27, 1837	55 53	1838	1838

The above copy of Township 1° 46' North of Range 1° 46' West of the Principal Meridian Michigan is a truly correct copy of the field notes of the survey based on file in this office which has been examined and approved.

Surveyor General's Office  
Oct. 25, Nov. 6, 1858

Monitors of			
Public Courses 1842	Public Courses 1842	Public Courses 1842	Public Courses 1842
42	30		

42-30

Charles Little  
Surveyor