

Township N<sup>o</sup> 28 N. Range N<sup>o</sup> 10 West Mer. (Mich.)

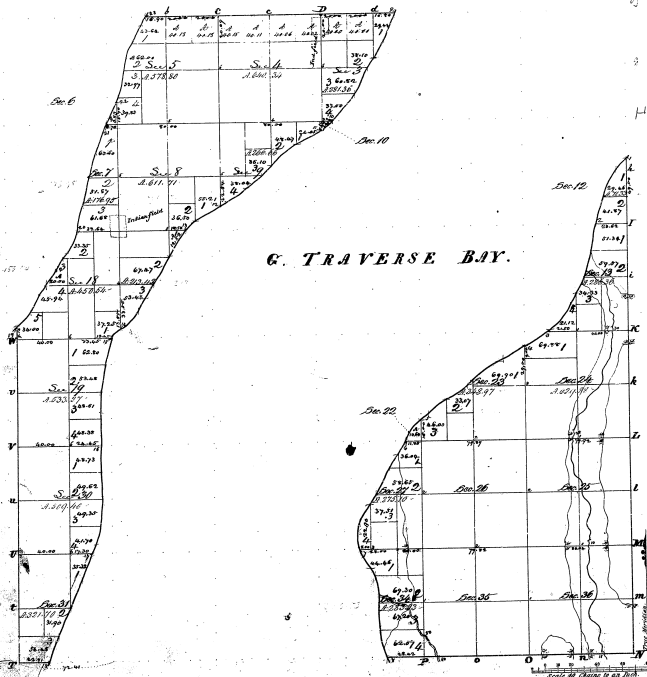

C. TRAVERSE BAY.

Section	Owner	Acres	Value
1	D. C. 12.57		
2	D. C. 12.57		
3	D. C. 12.57		
4	D. C. 12.57		
5	D. C. 12.57		
6	D. C. 12.57		
7	D. C. 12.57		
8	D. C. 12.57		
9	D. C. 12.57		
10	D. C. 12.57		
11	D. C. 12.57		
12	D. C. 12.57		
13	D. C. 12.57		
14	D. C. 12.57		
15	D. C. 12.57		
16	D. C. 12.57		
17	D. C. 12.57		
18	D. C. 12.57		
19	D. C. 12.57		
20	D. C. 12.57		
21	D. C. 12.57		
22	D. C. 12.57		
23	D. C. 12.57		
24	D. C. 12.57		
25	D. C. 12.57		
26	D. C. 12.57		
27	D. C. 12.57		
28	D. C. 12.57		
29	D. C. 12.57		
30	D. C. 12.57		
31	D. C. 12.57		
32	D. C. 12.57		
33	D. C. 12.57		
34	D. C. 12.57		
35	D. C. 12.57		
36	D. C. 12.57		

16-11  
16-11

Total number of Acres 9,128.82

Survey	By Whom Surveyed	Date of Survey	Area of Survey	When Surveyed	When Closed or
Survey	John A. Hays	1-21-1839	16.26.26	27-28-1839	3-27-1839
Subdivisions			37.26.62		

This above Map of Township N<sup>o</sup> 28 N. of Range N<sup>o</sup> 10 West  
 of the Principal Meridian Michigan is a copy of the original  
 original Christian Michener is hereby notified that the full area  
 of the above survey is hereby offered for sale and the proceeds  
 of the same are to be paid to the State of Michigan.  
 C. Stearns, Secy. of the State  
 Ann Arbor, Sept. 25 1839