

7 15 A R 11 6

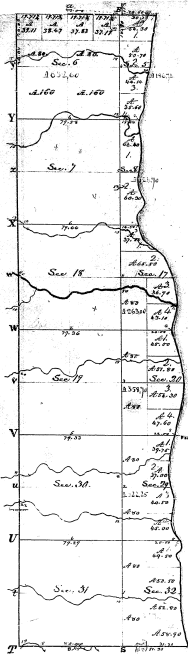

L A K E
H U R O N

Point	Course	Dist	Point	Course	Dist
1	N 75° 30'	100.00	2	N 75° 30'	100.00
2	N 75° 30'	100.00	3	N 75° 30'	100.00
3	N 75° 30'	100.00	4	N 75° 30'	100.00
4	N 75° 30'	100.00	5	N 75° 30'	100.00
5	N 75° 30'	100.00	6	N 75° 30'	100.00
6	N 75° 30'	100.00	7	N 75° 30'	100.00
7	N 75° 30'	100.00	8	N 75° 30'	100.00
8	N 75° 30'	100.00	9	N 75° 30'	100.00
9	N 75° 30'	100.00	10	N 75° 30'	100.00
10	N 75° 30'	100.00	11	N 75° 30'	100.00
11	N 75° 30'	100.00	12	N 75° 30'	100.00
12	N 75° 30'	100.00	13	N 75° 30'	100.00
13	N 75° 30'	100.00	14	N 75° 30'	100.00
14	N 75° 30'	100.00	15	N 75° 30'	100.00
15	N 75° 30'	100.00	16	N 75° 30'	100.00
16	N 75° 30'	100.00	17	N 75° 30'	100.00
17	N 75° 30'	100.00	18	N 75° 30'	100.00
18	N 75° 30'	100.00	19	N 75° 30'	100.00
19	N 75° 30'	100.00	20	N 75° 30'	100.00
20	N 75° 30'	100.00	21	N 75° 30'	100.00
21	N 75° 30'	100.00	22	N 75° 30'	100.00
22	N 75° 30'	100.00	23	N 75° 30'	100.00
23	N 75° 30'	100.00	24	N 75° 30'	100.00
24	N 75° 30'	100.00	25	N 75° 30'	100.00
25	N 75° 30'	100.00	26	N 75° 30'	100.00
26	N 75° 30'	100.00	27	N 75° 30'	100.00
27	N 75° 30'	100.00	28	N 75° 30'	100.00
28	N 75° 30'	100.00	29	N 75° 30'	100.00
29	N 75° 30'	100.00	30	N 75° 30'	100.00
30	N 75° 30'	100.00	31	N 75° 30'	100.00
31	N 75° 30'	100.00	32	N 75° 30'	100.00
32	N 75° 30'	100.00	33	N 75° 30'	100.00
33	N 75° 30'	100.00	34	N 75° 30'	100.00
34	N 75° 30'	100.00	35	N 75° 30'	100.00
35	N 75° 30'	100.00	36	N 75° 30'	100.00

25-18

25-18

Survey described	By whom surveyed	Date of completion	Amount of Survey	When Surveyed	Range and section
Subdivision Township line	Wm. C. Rice	11 Sep 1835	17 1/2 21 1/2	1835	14 1/2 21 1/2
	Wm. C. Rice	11 Sep 1835	17 1/2 21 1/2	1835	14 1/2 21 1/2

The above copy of Township 15 1/2 North of Range 15 1/2 West of the Principal Meridian of Mich. County is a true and correct copy of the survey shown on file in this office, taken here, surveyed and approved.

Surveyor General's Office,
Ann Arbor, Mich. 10 1835

W. T. Williams
Secy.