

Township N^o 43 N. Range N^o 32 W. Mer. Mich.

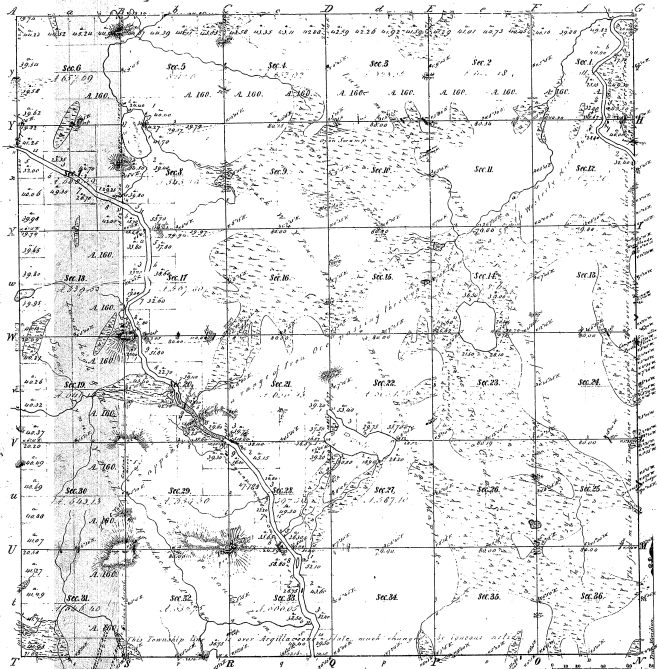

X

Bounders of		Bounders of	
Final Course	Dist	Final Course	Dist
	30		

44-30

Total number of Acres 332.3133

Survey described	To Whom Surveyed	Date of Grant	Amount of Survey	When Surveyed	When for use of the Sec. Co. was made
			332.3133	1855-1860	
Subdivisions	2223, B. Wade	April 27, 1869	82.08.70	1869	

The above Map of Township N^o 43 North of Range N^o 32 East of the Principal Meridian is a correct copy made to the field notes of the survey thereof on file in the office which have been examined and approved.

George G. Smith, U.S. Surveyor
Charles Foster, Supt.
 Office April 20, 1869

Original

PLAT OF AN ISLAND
 IN THE
MESQUACUMECUM OR PAINT RIVER,
 KNOWN AS LOT NO 20,
 T. 43 N. R. 32 W.
 MICH. MER.
 MICHIGAN.

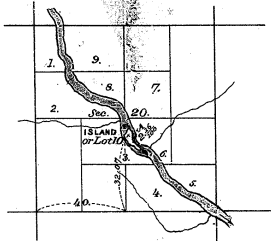

Scale 40 Chains to an Inch.

Department of the Interior,
 General Land Office,
 Jan. 21, 1884.

The above Diagram of an Island in the Mesquacumecum or Paint River, known as Lot No. 20, Section 20, T. 43 N. R. 32 W., Mich. Mer. State of Michigan, is a correct Plat of Survey executed by Charles D. Lawton, U.S. Deputy Surveyor, in pursuance of Instructions from the Commissioner of the General Land Office, bearing date the 19th. day of November, 1883, and is strictly conformable to the field notes thereof, which have been examined and approved.

W. D. McClelland

Commissioner & Ex-Officio Survt. Genl.
 of Michigan.

44-30