

Township 1° 45' N. Range 1° 33' W.

Mer. Mich.

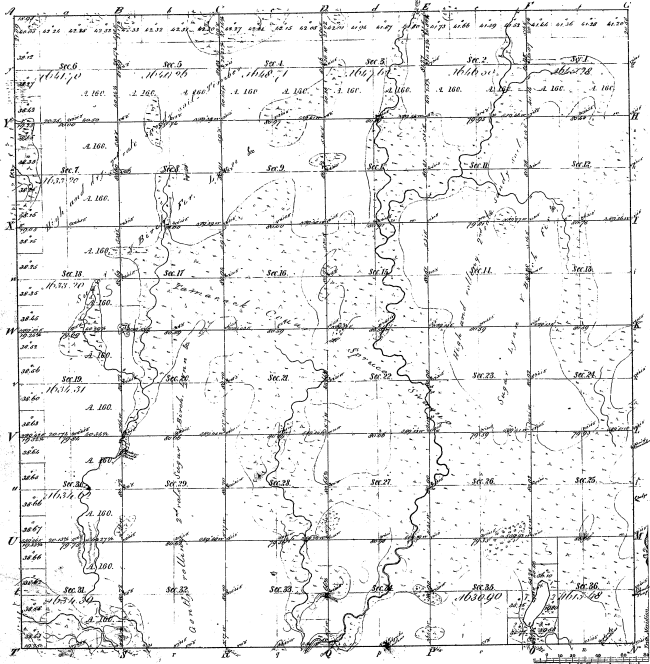

Boundaries of
Public Courses 1842-71 by Congress 1836-41 Public Courses 1822-35

44-22

44

Total number of Acres 1015.77

Survey designated	By whom surveyed	Date of Contract	Amount of Survey	When surveyed	Amount of land in the Sec. Cont. in ac.
Traverse Survey	Walter Marshall	Sept. 17 1847	4 68 33	1848	4 68 33
Subdivisions	Ray M. Childers	April 20 1847	64 26 29	1848	64 26 29

The above Map of Township 1° 45' North of Range 1° 33' West of the Principal Meridian Michigan is as nearly conformable to the field notes as the survey thereof on file in this Office which have been examined and approved.

Chicago, Seventh Office
Edward, June 10 1852.

Wm. S. Hall
Supt. Genl.