

Re Survey

Township 1° 26' N Range 1° 8' W Mer. Mich.

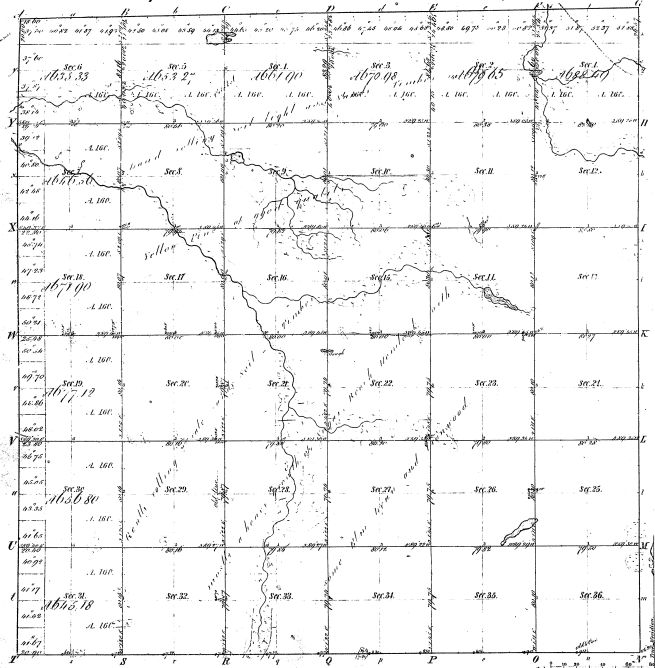

15-17

Manders of

Paul France 1862	Paul France 1862	Paul France 1862

Total number of Acres 23287.18

Survey designated	By Whom Surveyed	Date of Conduct	Amount of Survey	When Surveyed	Survey of the Sec 1/4 of the Sec 1/4
Township 1° 26' N Range 1° 8' W	J. P. Allard	Jan 24 1859	16 24 1/2	Jan 24 1859	
Subdivisions	W. H. Coulson	May 11 1862	194 54 3/4	May 11 1862	24 1/2
South Boundaries	W. H. Coulson	May 11 1862	6 00 90	May 11 1862	1/2

The above map of Township 1° 26' North of Range 1° 8' West of the Principal Meridian Michigan is strictly conformable to the field notes of the survey thereof on file in this office which have been examined and approved.

George Sargent Office }  
 Robert, Jan 26 1863 }  
 (Main Office }  
 Station! }