

201
1826

	1826	1827	1828	1829	1830	1831	1832
2211.72							
2212.01	S. 7	S. 8	S. 9	S. 10	S. 11	S. 12	
2213.00							
2214.74	S. 15	S. 17	S. 18	S. 19	S. 20	S. 21	
2215.72							
2216.44	S. 19	S. 20	S. 21	S. 22	S. 23	S. 24	
2217.00							
2218.11	S. 20	S. 21	S. 22	S. 23	S. 24	S. 25	
2219.20							
2220.01	S. 21	S. 22	S. 23	S. 24	S. 25	S. 26	
2221.51							

Inventory and abstracting the following are changed in the next of this volume in number 1826
 Total \$4,999.39

A true copy from the original, filed in this office at Savannah by John Lane, Feb. 1826
 Treasurer General Office
 Charleston July 1st 1826

[Handwritten signature]

Township N^o 9 S., Range N^o 1 E. Mer. (Mic.)

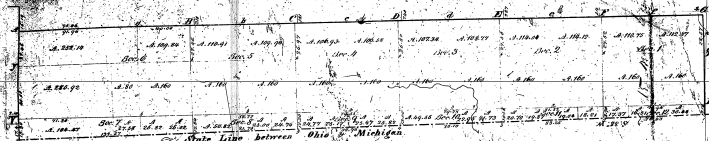

Surveyed in 1852 by John Hoover, Deputy Surveyor
Conformed with State Plan in 1857 by Andrew Schuchman, Clerk

PUBL. COPY

I certify that the above is a true copy of the
original plat in this office.
Surveyor General's Office,
Cincinnati, Ohio, 22nd Feb. 1858.

Robt. Wolfe