

Township 1° 45. N.; Range 1° 8 West Mex. Mich.

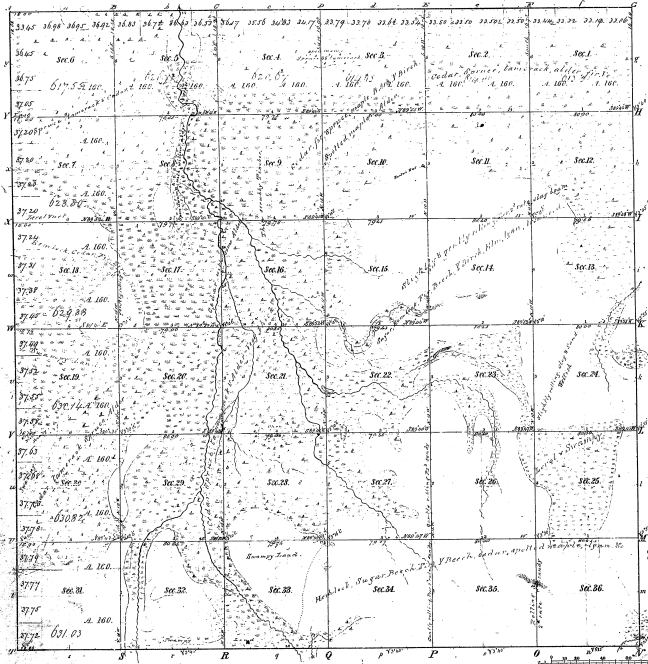

Members of
 Prob. Course 1854 Prob. Course 1852 Prob. Course 1851

30 20

35-25

Total number of Acres. 22,856.77

| Survey Designated | By Whom Surveyed | Date of Completion | Amount of Survey | When Surveyed | When Noted and set out on the Survey |
|-------------------|------------------|--------------------|------------------|---------------|--------------------------------------|
| Township lines | W. A. K. 1854 | Jan. 21, 1854 | 36 | 1854 | 1854 |
| Subdivisions | W. A. K. 1854 | Jan. 7, 1854 | 59.59 | 1854 | 1854 |

The above Map of Township 1° 45 North of Range 1° 8 West of the 10th Principal Meridian, Michigan, is hereby confirmed to the full extent of the survey thereof on file in this Office which have been examined and approved.

Surveyor General's Office.
 Detroit, January 11, 1850

Charles A. B. [Signature] Gen'l. Supt.