

Township 1° 46' N Range 1° 22' W Mer. Mich.

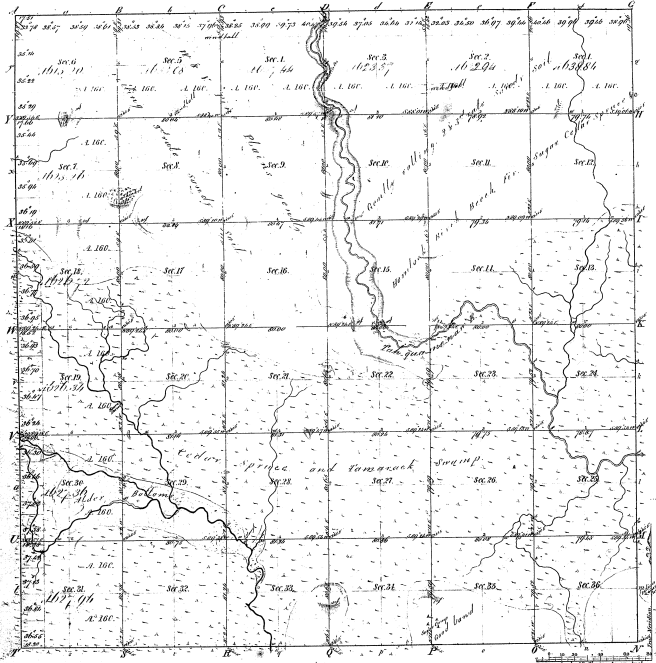

Boundaries of
 Pre-1836 Grants
 1836-40
 1840-44
 1844-48
 1848-52
 1852-56
 1856-60
 1860-64
 1864-68
 1868-72
 1872-76
 1876-80
 1880-84
 1884-88
 1888-92
 1892-96
 1896-1900

36-20

Total number of Acres 27,912.64

Survey designated	By whom surveyed	Date of Contract	Amount of Survey	When Surveyed	By whom surveyed
Township - Area	Wm. A. Beach	April 2, 1854	76 57 28	June 1854	
Subdivisions	Thomas Coleman	April 9, 1857	59 76 19	5 th Decr 1857	

The above map of Township 15 of Range 19 is strictly conformable to the field notes of the survey thereon made in the office which have been examined and approved.

Surveyor General's Office
 Detroit June 25 1882
 Charles W. Cole, Surveyor General