

Township N^o 40 N. Range N^o 3 W.

Sec. 18.

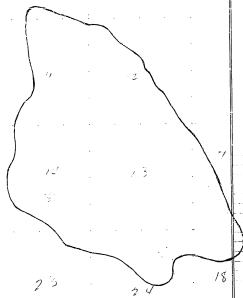

LAKE HURON.



Acres	Feet	Inches	Cent	Mils	Other
48	31				

Total number of Acres 585.60

Survey Disposed	By Whom Surveyed	Date of Contract	Amount of Survey in Acres	When Surveyed	When Closed in the State Survey
Township Lines	D. A. Bush	Aug 21 1840	57 60	1840	
Subdivisions	J. B. Mullett	April 2 1845	2 27 96	25 60	1845

The above list of Townships 1 to 30 South of Range 3 West of the Principal Meridian Michigan is a copy of a list of the principal surveys of the said range which has been examined and approved.
 Surveyor General's Office.
 Detroit, Wisconsin 18 1845
 Lucas Dyer, Secy Genl

45-31

TOWNSHIPS NO.40 NORTH, RANGES NOS.2 AND 3 WEST, OF THE MICHIGAN MERIDIAN, MICHIGAN.

PLAT OF ROUND ISLAND IN THE STRAITS OF MACKINAC.

48-31

48-31

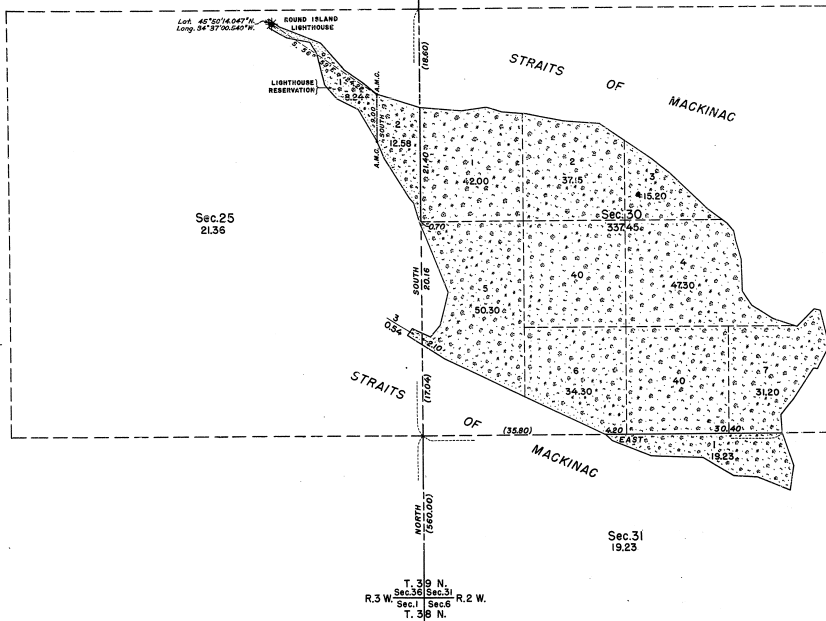

MEMORANDUM.

THIS PLAT DELINEATES THE SURVEY OF ROUND ISLAND IN THE STRAITS OF MACKINAC, WHICH WAS NOT INCLUDED IN PRIOR OFFICIAL SURVEYS IN THIS LOCALITY.

THE EAST BOUNDARY OF THE ROUND ISLAND LIGHTHOUSE RESERVATION IN SECTION 25, T. 40 N., R. 3 W., HAS BEEN ESTABLISHED ON THE ISLAND IN THE POSITION DESCRIBED IN EXECUTIVE ORDER NO. 2313 DATED NOVEMBER 25, 1930.

THE SURVEY WAS EXECUTED PURSUANT TO AUTHORITY CONTAINED IN GENERAL LAND OFFICE LETTER 1861775 "C" DATED AUGUST 19, 1941.

T. 39 N.
R. 3 W. Sec. 1 Secs. 2 & 3 R. 2 W.
T. 38 N.

Sec.31
19.23

SCALE: 1 INCH EQUALS TO CHAINS.

AREA SURVEYED, 378.04 ACRES.

LINES DESIGNATED	BY WHOM SURVEYED	GROUP NO.	DATE OF		WHEN SURVEYED
			SPECIAL INSTRUCTIONS	BEGUN COMPLETED	
SUBDIVISIONAL	HAL D. CRAIG	50	JULY 15, 1942.	AUGUST 26, SEPTEMBER 7, 1942.	
BEARER CONNECTION	NORVILLE E. BREARER				

UNITED STATES DEPARTMENT OF THE INTERIOR.
GENERAL LAND OFFICE.

DENVER, COLORADO, NOVEMBER 27, 1943.
THIS PLAT OF ROUND ISLAND IN TOWNSHIPS NO. 40 NORTH, RANGES NOS. 2 AND 3 WEST, OF THE MICHIGAN MERIDIAN, MICHIGAN, IS STRICTLY CONFORMABLE TO THE FIELD NOTES OF THE SURVEY THEREOF, WHICH HAVE BEEN EXAMINED AND APPROVED.

WASHINGTON, D. C., DECEMBER 7, 1943.
THE SURVEY REPRESENTED BY THIS PLAT, HAVING BEEN CORRECTLY EXECUTED IN ACCORDANCE WITH THE REQUIREMENTS OF LAW AND THE REGULATIONS OF THIS OFFICE, IS HEREBY ACCEPTED.

James H. Fisher
SUPERVISOR OF SURVEYS.

John R. Wolf
ASSISTANT COMMISSIONER.