

T 3 N R 15 E

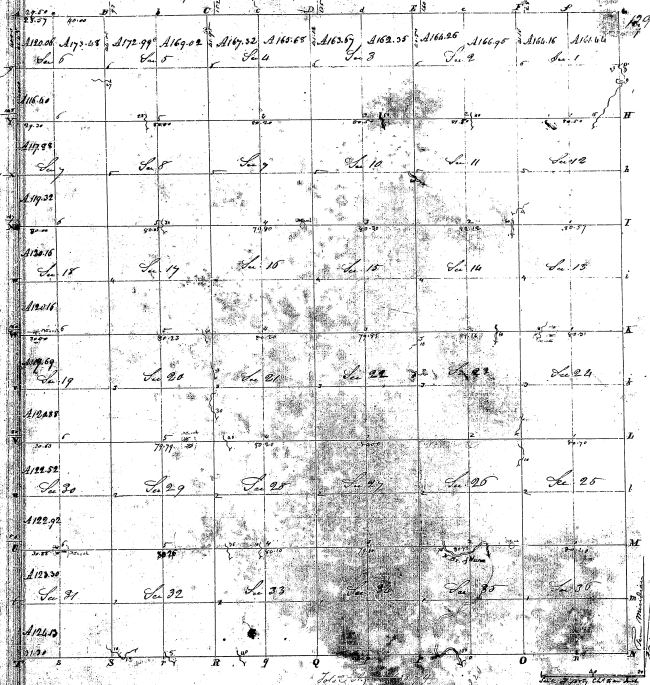

32-23
32-23

Township N. 3 North, Range N. 15 East of Mer. (Mich. Ter.)

Pursuant to Contract and Instructions from Edward Puffer Deputy Surveyor General of the United States and date the twelfth day of November 1816 I have administered, laid out and surveyed the above described Township and do hereby certify that it had such and such bounds both natural and artificial as represented on said Plan and described in the field notes made thereof and returned with this Plan to the Surveyor General Office on the 12th day of April 1817.

William Paxton, Sr.