

Township N^o 44 N Range N^o 26 W Mer. Mich.

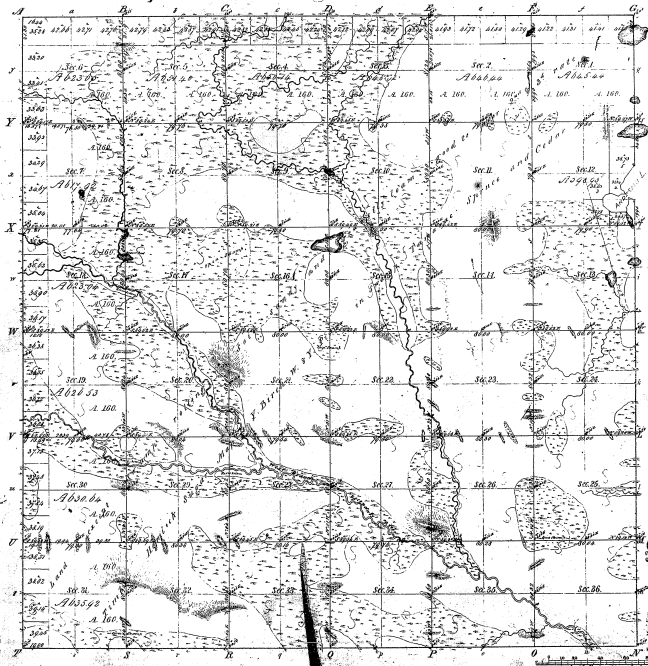

Minutes of
Town Council 1848

1848	1849	1850	1851	1852	1853	1854	1855	1856	1857	1858	1859	1860	1861	1862	1863	1864	1865	1866	1867	1868	1869	1870	1871	1872	1873	1874	1875	1876	1877	1878	1879	1880	1881	1882	1883	1884	1885	1886	1887	1888	1889	1890	1891	1892	1893	1894	1895	1896	1897	1898	1899	1900
------	------	------	------	------	------	------	------	------	------	------	------	------	------	------	------	------	------	------	------	------	------	------	------	------	------	------	------	------	------	------	------	------	------	------	------	------	------	------	------	------	------	------	------	------	------	------	------	------	------	------	------	------

Minutes of 1848

38-16

Total number of Acres 22,953.30

Survey designated	By Whom Surveyed	Date of Contract	Amount of Survey	Acres	Surveyed	Acres	Not Surveyed	Acres
Township	D. H. H. H.	1848	22,953.30	22,953.30				
Section	H. H. H.	1848	100	100				
Section	H. H. H.	1848	100	100				

The above map of Township N^o 44 N Range N^o 26 W of the
Principal Meridian of Michigan is hereby confirmed to the full extent
of the survey thereof by the Town Council here now assembled and approved.
Surveyor General
C. A. Chapman