

Township 1° 45. N Range 1° 26 W Mer. Mich.

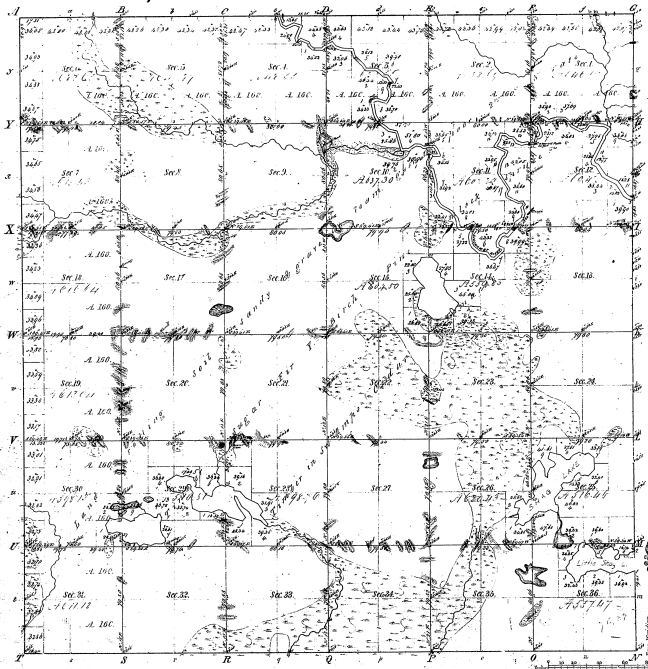

Number of  
Public Courses 1824 Public Courses 1824

38-13

38-13

Meridian of 1824, 1824

Total number of Acres 22,297.61

Acres Designated	By Whom Designated	Date of Contract	Amount of Acres	When Surveyed	How far and in what direction from the Sec. Corner
10.000000	D. Houghton	Jan. 27 1844	10.000000	1844	1/2 Sec. 11
12.297661	A. H. H. H.	Jan. 27 1844	12.297661	1844	1/2 Sec. 11

The above Map of Township 15 45 N of Range 15 26 W of the Principal Meridian of Michigan is a true and correct copy of the original map on file in this Office which has been examined and approved.

Surveyor General's Office  
Detroit August 1852

David Chapman  
Surveyor