

Township N^o 46. N. Range N^o 28 W. Mer. Mich.

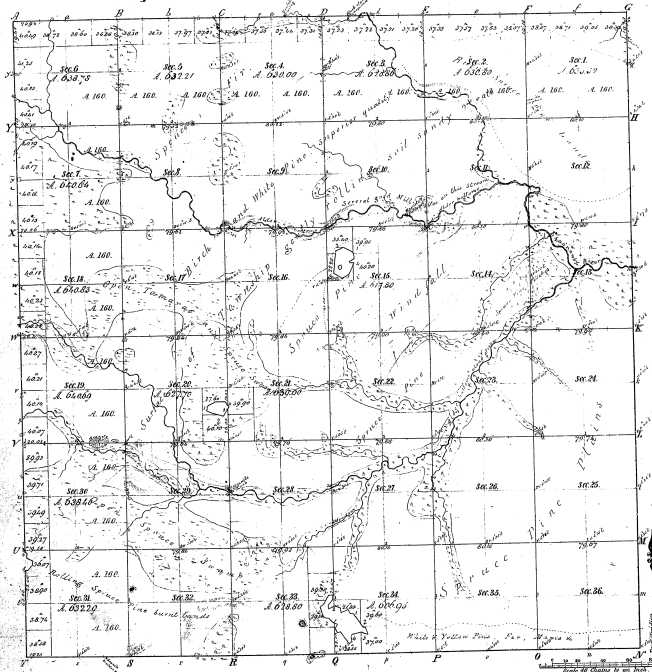

Mileage of		Mileage of	
Post Course 1874	Post Course 1875	Post Course 1876	Post Course 1877
39.3			
Total. Meters 2 miles or less 5 miles			

39.39

Total number of Acres 22,010.17

Survey Designated	By Whom Surveyed	Date of Contract	Amount of Survey	When Surveyed	How far and in what direction from the corner
Township	Haver, Mellen	Band of Dec 1885	25.08.01	2-25-85	116
Subdivisions	Haver, Mellen	Band of Dec 1885	25.08.01	2-25-85	116

The above copy of Township N^o 46. N. Range N^o 28 W. Mer. of the Principal Meridian Michigan is hereby confirmed, to the full extent of the survey thereon, in the office, which has been examined and approved. Surveyor General's Office, Detroit, January 27, 1886. Lucius Lyon, Sp. Com.