

Township 1° 51' N. Range N° 28 W. Mer. Mich.

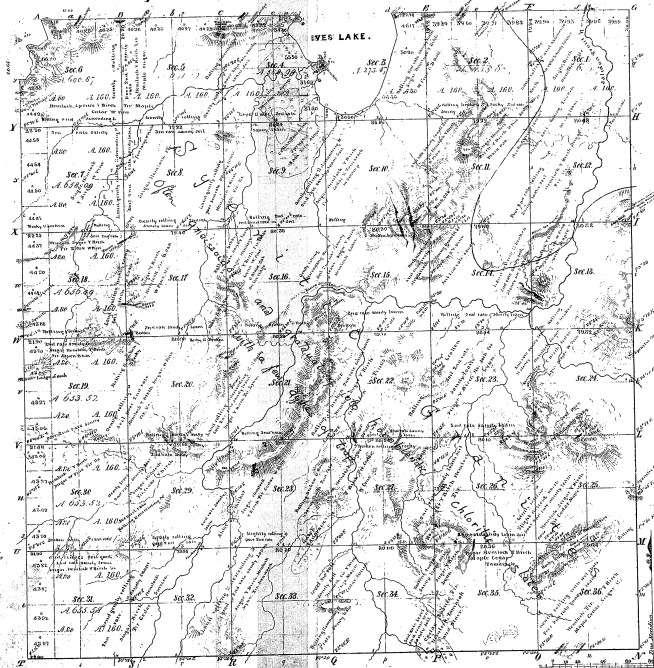

Members of  
 First Course 1848  
 39-10

Public Courses 1848  
 37

Third Course 1848

39-15

Total number of Acres 22,630. 63

Range described	By Whom Surveyed	Date of Contract	Amount of Survey	When Surveyed	Amount of land in the Survey
Township One Subdivisions	Wm. L. Sullivan	June 20 1848	2 33 16	8 17 1848	20 63 47
	Hollister & Co.	Sept 7 1848	63 00 00	20 63 1848	

The above map of Township 1° 51' North of Range 1° 28 West of the Principal Meridian with its axes of the survey thereof on file in this Office, which have been examined and approved.

George Sewell, Clerk of the Board of Commissioners  
 Dec 11 1848

Lucius Lyon, Surveyor