

Township 1° 36' N. Range N° 25 W. Mer. Mich.

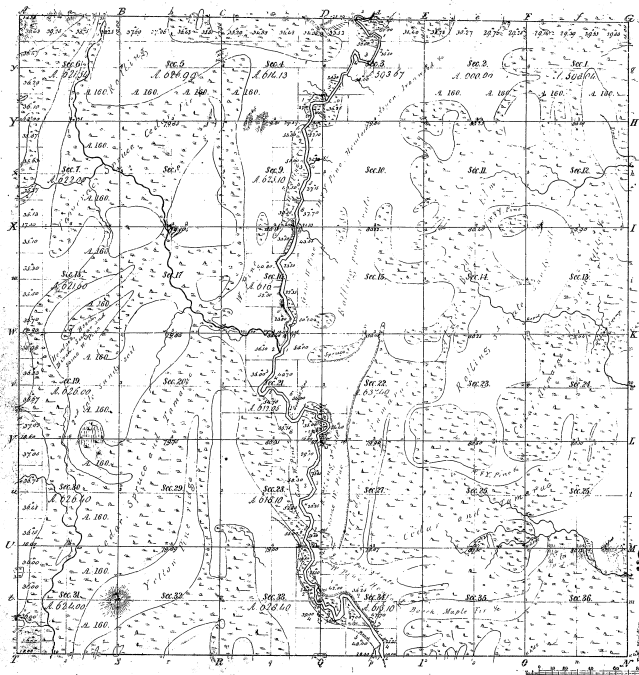

47-13

Traverse of	Point	Course	Dist.	Point	Course	Dist.	Point	Course	Dist.
Total traverses 11 miles 29 fms 10 cds.									

Total number of Acres 22,646.58

Survey Designated	By Whom Surveyed	Date of Original	Amount of Survey	When Surveyed	Who Surveyed
Township lines	John W. Mallett	March 21 1870	36	1870	Mallett
Section lines	John W. Mallett	March 21 1870	2,160	1870	Mallett
Section lines	John W. Mallett	Dec. 22 1868	16.29	1868	Mallett

The above map of Township 1° 36' North of Range 1° 25 West of the Principal Meridian Michigan is hereby approved by the following officers of the Surveying office on file in this office which have been examined and approved.

Surveyor General's Office
Detroit Dec. 22 1868

Deane L. Spurr, Surveyor