

Township N. 27 North, Range N. 2 East Mer. (Mia. Ter.)

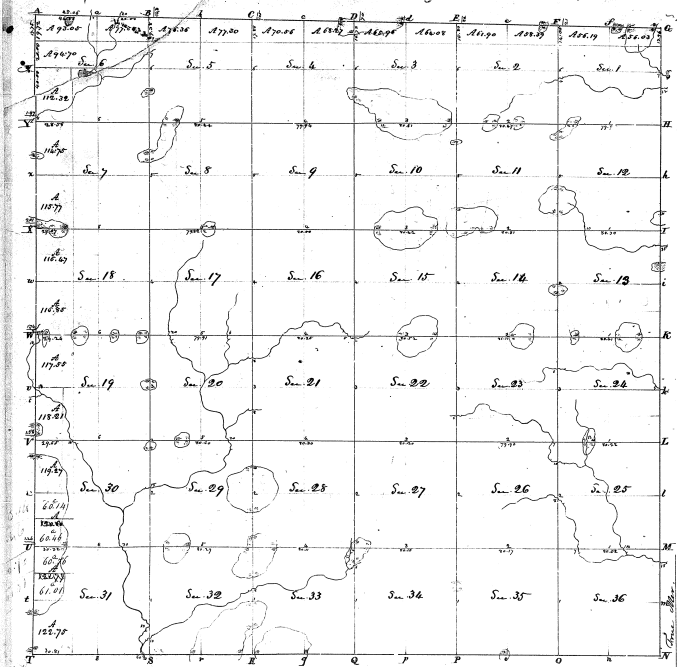

Surveyed in April, 1831, by Henry Roberts & S.

The above plat of Township N. 27 N. of Range N. 2 E. of the principal Meridian (Mia. Ter.) is strictly conformable to the field notes of the surveyor thereof, on file in this Office which have been examined & approved.
 Surveyor General's Office, S.
 M. T. Sullivan

Sections		Contents		
Section	Acres	Section	Acres	
N. 18	1	33.00	62-19	32.00
32	32.00	62-20	32.00	
32	32.00	62-21	32.00	
32	32.00	62-22	32.00	
32	32.00	62-23	32.00	
32	32.00	62-24	32.00	
32	32.00	62-25	32.00	
32	32.00	62-26	32.00	
32	32.00	62-27	32.00	
32	32.00	62-28	32.00	
32	32.00	62-29	32.00	
32	32.00	62-30	32.00	
32	32.00	62-31	32.00	
32	32.00	62-32	32.00	
32	32.00	62-33	32.00	
32	32.00	62-34	32.00	
32	32.00	62-35	32.00	
32	32.00	62-36	32.00	
32	32.00	62-37	32.00	
32	32.00	62-38	32.00	
32	32.00	62-39	32.00	
32	32.00	62-40	32.00	
32	32.00	62-41	32.00	
32	32.00	62-42	32.00	
32	32.00	62-43	32.00	
32	32.00	62-44	32.00	
32	32.00	62-45	32.00	
32	32.00	62-46	32.00	
32	32.00	62-47	32.00	
32	32.00	62-48	32.00	
32	32.00	62-49	32.00	
32	32.00	62-50	32.00	
32	32.00	62-51	32.00	
32	32.00	62-52	32.00	
32	32.00	62-53	32.00	
32	32.00	62-54	32.00	
32	32.00	62-55	32.00	
32	32.00	62-56	32.00	
32	32.00	62-57	32.00	
32	32.00	62-58	32.00	
32	32.00	62-59	32.00	
32	32.00	62-60	32.00	
32	32.00	62-61	32.00	
32	32.00	62-62	32.00	
32	32.00	62-63	32.00	
32	32.00	62-64	32.00	
32	32.00	62-65	32.00	
32	32.00	62-66	32.00	
32	32.00	62-67	32.00	
32	32.00	62-68	32.00	
32	32.00	62-69	32.00	
32	32.00	62-70	32.00	
32	32.00	62-71	32.00	
32	32.00	62-72	32.00	
32	32.00	62-73	32.00	
32	32.00	62-74	32.00	
32	32.00	62-75	32.00	
32	32.00	62-76	32.00	
32	32.00	62-77	32.00	
32	32.00	62-78	32.00	
32	32.00	62-79	32.00	
32	32.00	62-80	32.00	
32	32.00	62-81	32.00	
32	32.00	62-82	32.00	
32	32.00	62-83	32.00	
32	32.00	62-84	32.00	
32	32.00	62-85	32.00	
32	32.00	62-86	32.00	
32	32.00	62-87	32.00	
32	32.00	62-88	32.00	
32	32.00	62-89	32.00	
32	32.00	62-90	32.00	
32	32.00	62-91	32.00	
32	32.00	62-92	32.00	
32	32.00	62-93	32.00	
32	32.00	62-94	32.00	
32	32.00	62-95	32.00	
32	32.00	62-96	32.00	
32	32.00	62-97	32.00	
32	32.00	62-98	32.00	
32	32.00	62-99	32.00	
32	32.00	62-100	32.00	

138

6