

T O S R E E N O A P P
 20 21 22 23 24
 25 26 27 28 29 30
 31 32 33 34 35 36
 37 38 39 40 41 42
 43 44 45 46 47 48
 49 50 51 52 53 54
 55 56 57 58 59 60
 61 62 63 64 65 66

Ground line survey
 July 28, 1854

I hereby certify that the above is a plat of the 36 sections
 made under the act of the 20th January 1820 of the territorial state
 T. H. S. & C. J. Cook, Secy. T. H. S. & C.
 J. H. Miller
 Secy. of the Territorial state

31-31

FILE
 Plat 1854-1855
 Sec. 31-31

1854

1/4 A. N. 20 3/4
 Consistent to a contract with said section line from Board of Survey General of the United States having into the survey
 I have administered said soil and homages the above described, and do hereby certify that 12 1/2 acres and about
 land both national and territorial are represented on said plat and included in the above described survey
 with the plat into the Survey General Office. Certificate this 30th day of June 1854
 J. H. Miller
 Secy. of the Territorial state

T S S R S E

31-37

31-37 (6)

Section	Acres	Value
11	178 1/2	8.00
	177 1/2	8.00
	176 1/2	8.00
	175 1/2	8.00
9	174 1/2	18.50
8	173 1/2	7.00
	172 1/2	6.50
	171 1/2	6.50
	170 1/2	6.50
	169 1/2	6.50
	168 1/2	6.50
	167 1/2	6.50
	166 1/2	6.50
7	165 1/2	6.50
6	164 1/2	8.00
	163 1/2	8.00
	162 1/2	8.00
	161 1/2	8.00
5	160 1/2	22.00
	159 1/2	22.00
4	158 1/2	14.00
3	157 1/2	4.00
	156 1/2	4.00
	155 1/2	4.00
2	154 1/2	6.00



Section	By whom conveyed	Date of Conveyance	As by Survey	Value	Remarks
1
2
3
4
5
6
7
8
9
10
11

The above Map of Township N. 8 P. of Range N. 3 E. Mer. (Mer. 101) is hereby confirmed to the file notes of the Survey thereof on file in this Office, which have been examined & approved.

Surveyor General's Office. } B. H. H. by the Surveyor
 Cincinnati, Sept. 30, 1835

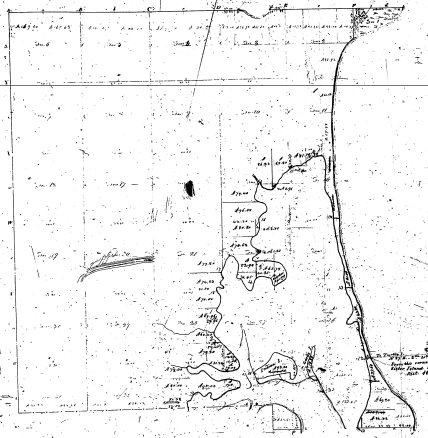

Township 41^N Range 12^W West of 100th Meridian (1892) Surveyed by George H. ...

Dimensions of ...

Section	Acres	Remarks	Acres	Remarks
1	36.00	Section 1	36.00	Section 1
2	36.00	Section 2	36.00	Section 2
3	36.00	Section 3	36.00	Section 3
4	36.00	Section 4	36.00	Section 4
5	36.00	Section 5	36.00	Section 5
6	36.00	Section 6	36.00	Section 6
7	36.00	Section 7	36.00	Section 7
8	36.00	Section 8	36.00	Section 8
9	36.00	Section 9	36.00	Section 9
10	36.00	Section 10	36.00	Section 10
11	36.00	Section 11	36.00	Section 11
12	36.00	Section 12	36.00	Section 12
13	36.00	Section 13	36.00	Section 13
14	36.00	Section 14	36.00	Section 14
15	36.00	Section 15	36.00	Section 15
16	36.00	Section 16	36.00	Section 16
17	36.00	Section 17	36.00	Section 17
18	36.00	Section 18	36.00	Section 18
19	36.00	Section 19	36.00	Section 19
20	36.00	Section 20	36.00	Section 20
21	36.00	Section 21	36.00	Section 21
22	36.00	Section 22	36.00	Section 22
23	36.00	Section 23	36.00	Section 23
24	36.00	Section 24	36.00	Section 24
25	36.00	Section 25	36.00	Section 25
26	36.00	Section 26	36.00	Section 26
27	36.00	Section 27	36.00	Section 27
28	36.00	Section 28	36.00	Section 28
29	36.00	Section 29	36.00	Section 29
30	36.00	Section 30	36.00	Section 30
31	36.00	Section 31	36.00	Section 31
32	36.00	Section 32	36.00	Section 32
33	36.00	Section 33	36.00	Section 33
34	36.00	Section 34	36.00	Section 34
35	36.00	Section 35	36.00	Section 35
36	36.00	Section 36	36.00	Section 36

31-37



UNITED STATES
DEPARTMENT OF THE INTERIOR
BUREAU OF LAND MANAGEMENT
EASTERN STATES OFFICE
WASHINGTON 25, D. C.

IN REPLY REFER TO:

5.21:RSE

APR 30 1957

Mr. J. D. Stephansky
Assistant Chief
Lands Division
Department of Conservation
Lansing 26, Michigan

Dear Mr. Stephansky:

In reply to your inquiry of April 24 relative to which of two surveys, the Wampler or Clark, of Keweenaw (Kiam) Bay in T. 8 S., R. 6 E., Mich. Wm., Michigan, are the official surveys, you are advised that the Clark surveys are the official ones. This survey of Keweenaw Bay is shown upon that plat dated December 10, 1827, although these figures are dim and almost illegible upon our plat, as apparently prepared from the Clark field notes of November, 1827.

No explanation can be offered as to why the Wampler plat of 1820 was used for purposes of swamp land selections in this area in lieu of the corrected surveys by Clark.

Sincerely yours,

L. T. Hoffman
Luther T. Hoffman
Supervisor

*Order copy of
Clark's survey plat
of 1827.*

RECEIVED
MAY 2 1957
LANDS DIVISION

T. 8 S., R. 8 E., MICHIGAN.

Township N. 13 South, Range 11 East Mer. (1867)

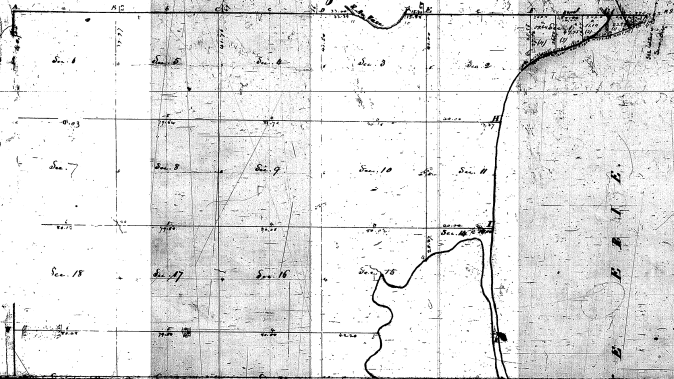

Acres		Cents	
1	320	1	320
2	320	2	640
3	320	3	960
4	320	4	1280
5	320	5	1600
6	320	6	1920
7	320	7	2240
8	320	8	2560
9	320	9	2880
10	320	10	3200
11	320	11	3520
12	320	12	3840
13	320	13	4160
14	320	14	4480
15	320	15	4800
16	320	16	5120
17	320	17	5440
18	320	18	5760
19	320	19	6080
20	320	20	6400
21	320	21	6720
22	320	22	7040
23	320	23	7360
24	320	24	7680
25	320	25	8000
26	320	26	8320
27	320	27	8640
28	320	28	8960
29	320	29	9280
30	320	30	9600
31	320	31	9920
32	320	32	10240
33	320	33	10560
34	320	34	10880
35	320	35	11200
36	320	36	11520



37	640	37	640
38	640	38	1280
39	640	39	1920
40	640	40	2560
41	640	41	3200
42	640	42	3840
43	640	43	4480
44	640	44	5120
45	640	45	5760
46	640	46	6400
47	640	47	7040
48	640	48	7680
49	640	49	8320
50	640	50	8960
51	640	51	9600
52	640	52	10240
53	640	53	10880
54	640	54	11520
55	640	55	12160
56	640	56	12800
57	640	57	13440
58	640	58	14080
59	640	59	14720
60	640	60	15360
61	640	61	16000
62	640	62	16640
63	640	63	17280
64	640	64	17920
65	640	65	18560
66	640	66	19200
67	640	67	19840
68	640	68	20480
69	640	69	21120
70	640	70	21760
71	640	71	22400
72	640	72	23040

Ottawa Indian Reserve

Surveyed in 1820 by Joseph Meade Esq.

A true copy of the original filed in this office

Map

10991

T. 8 S. R. 8 E.

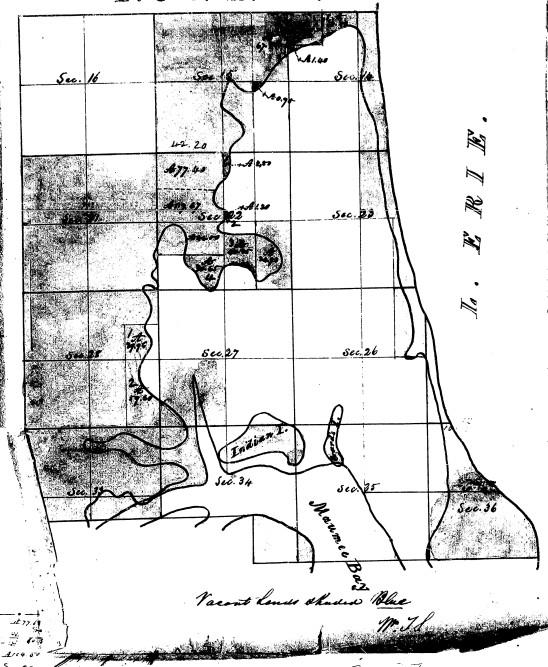

I. E. R. I. E.

Francis Lewis Wheeler

F. L.

31 37

16

17

16

Department of the Interior, Bureau of Land Management

Sectional Table

Description of the Land, Township, on the Sectional Table

Section	Description	Acres	Value	Remarks
1				
2				
3				
4				
5				
6				
7				
8				
9				
10				
11				
12				
13				
14				
15				
16				
17				
18				
19				
20				
21				
22				
23				
24				
25				
26				
27				
28				
29				
30				
31				
32				
33				
34				
35				
36				
37				
38				
39				
40				
41				
42				
43				
44				
45				
46				
47				
48				
49				
50				
51				
52				
53				
54				
55				
56				
57				
58				
59				
60				
61				
62				
63				
64				
65				
66				
67				
68				
69				
70				
71				
72				
73				
74				
75				
76				
77				
78				
79				
80				
81				
82				
83				
84				
85				
86				
87				
88				
89				
90				
91				
92				
93				
94				
95				
96				
97				
98				
99				
100				

Sectional Table

Date		Description		Amount		Balance	
Day	Month	Particulars	Debit	Credit	Debit	Credit	Balance
1	1880	to Balance					
2	1880	to Cash					
3	1880	to Cash					
4	1880	to Cash					
5	1880	to Cash					
6	1880	to Cash					
7	1880	to Cash					
8	1880	to Cash					
9	1880	to Cash					
10	1880	to Cash					
11	1880	to Cash					
12	1880	to Cash					
13	1880	to Cash					
14	1880	to Cash					
15	1880	to Cash					
16	1880	to Cash					
17	1880	to Cash					
18	1880	to Cash					
19	1880	to Cash					
20	1880	to Cash					
21	1880	to Cash					
22	1880	to Cash					
23	1880	to Cash					
24	1880	to Cash					
25	1880	to Cash					
26	1880	to Cash					
27	1880	to Cash					
28	1880	to Cash					
29	1880	to Cash					
30	1880	to Cash					
31	1880	to Cash					
1	1881	to Cash					
2	1881	to Cash					
3	1881	to Cash					
4	1881	to Cash					
5	1881	to Cash					
6	1881	to Cash					
7	1881	to Cash					
8	1881	to Cash					
9	1881	to Cash					
10	1881	to Cash					
11	1881	to Cash					
12	1881	to Cash					
13	1881	to Cash					
14	1881	to Cash					
15	1881	to Cash					
16	1881	to Cash					
17	1881	to Cash					
18	1881	to Cash					
19	1881	to Cash					
20	1881	to Cash					
21	1881	to Cash					
22	1881	to Cash					
23	1881	to Cash					
24	1881	to Cash					
25	1881	to Cash					
26	1881	to Cash					
27	1881	to Cash					
28	1881	to Cash					
29	1881	to Cash					
30	1881	to Cash					
31	1881	to Cash					
1	1882	to Cash					
2	1882	to Cash					
3	1882	to Cash					
4	1882	to Cash					
5	1882	to Cash					
6	1882	to Cash					
7	1882	to Cash					
8	1882	to Cash					
9	1882	to Cash					
10	1882	to Cash					
11	1882	to Cash					
12	1882	to Cash					
13	1882	to Cash					
14	1882	to Cash					
15	1882	to Cash					
16	1882	to Cash					
17	1882	to Cash					
18	1882	to Cash					
19	1882	to Cash					
20	1882	to Cash					
21	1882	to Cash					
22	1882	to Cash					
23	1882	to Cash					
24	1882	to Cash					
25	1882	to Cash					
26	1882	to Cash					
27	1882	to Cash					
28	1882	to Cash					
29	1882	to Cash					
30	1882	to Cash					
31	1882	to Cash					