

Township N. 10 N., Range N. 6 West Mer. (Mich.)

63

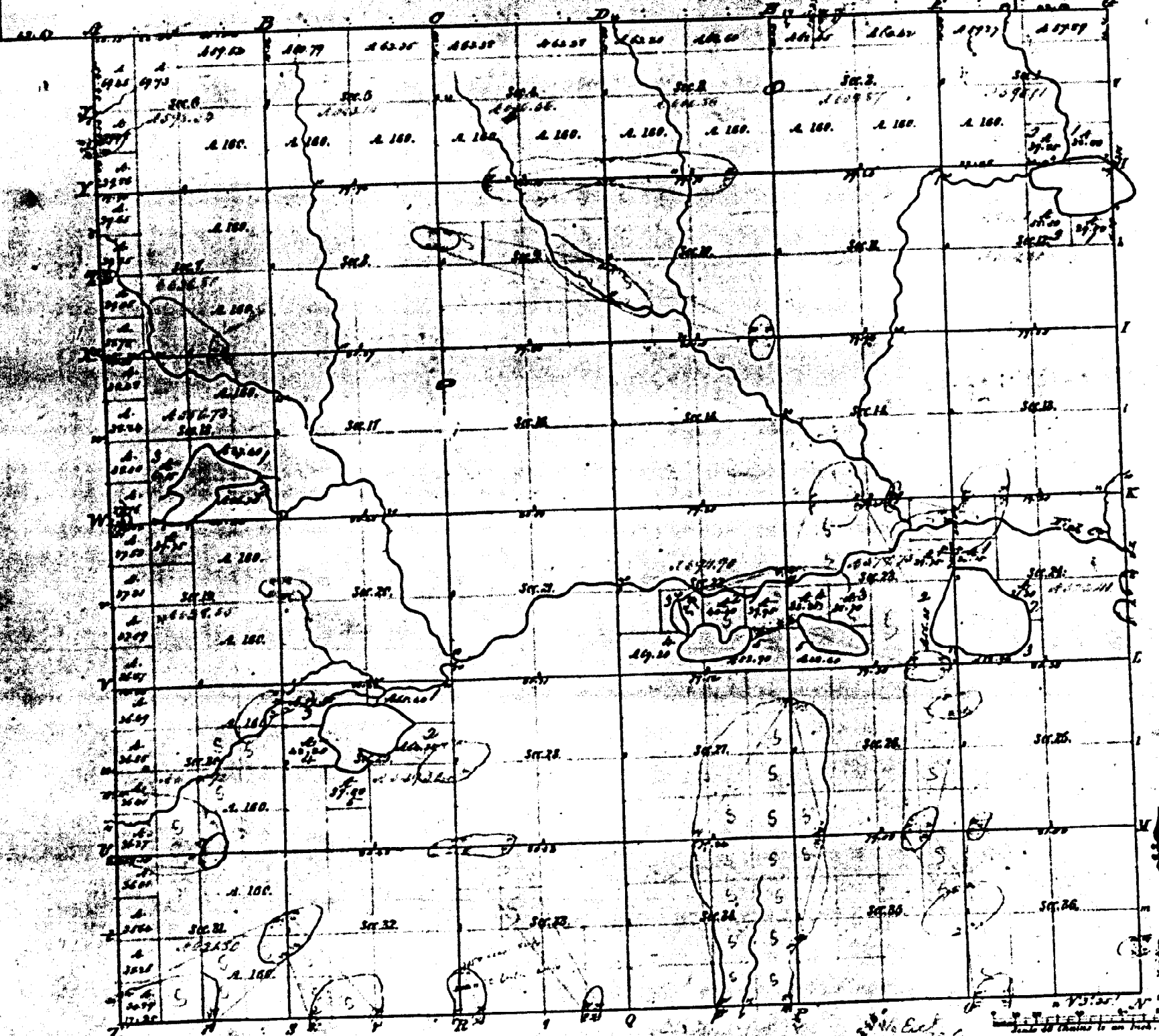

Mansions of Inland.			
Point	Course	Dist.	Point
Station No. 13120			
3.	N 75° W	2.00	751 W
	N 75° W	14.00	752 G
	N 75° W	17.00	753 W
	N 75° W	15.00	754 G
	N 75° W	15.00	755 G
Station No. 13110			
	N 75° W	11.00	756 W
	N 75° W	12.00	757 G
	N 75° W	12.00	758 W
	N 75° W	12.00	759 G
	N 75° W	12.00	760 W
	N 75° W	12.00	761 G
	N 75° W	12.00	762 W
	N 75° W	12.00	763 G
	N 75° W	12.00	764 W
	N 75° W	12.00	765 G
	N 75° W	12.00	766 W
	N 75° W	12.00	767 G
	N 75° W	12.00	768 W
	N 75° W	12.00	769 G
	N 75° W	12.00	770 W
	N 75° W	12.00	771 G
	N 75° W	12.00	772 W
	N 75° W	12.00	773 G
	N 75° W	12.00	774 W
	N 75° W	12.00	775 G
	N 75° W	12.00	776 W
	N 75° W	12.00	777 G
	N 75° W	12.00	778 W
	N 75° W	12.00	779 G
	N 75° W	12.00	780 W
	N 75° W	12.00	781 G
	N 75° W	12.00	782 W
	N 75° W	12.00	783 G
	N 75° W	12.00	784 W
	N 75° W	12.00	785 G
	N 75° W	12.00	786 W
	N 75° W	12.00	787 G
	N 75° W	12.00	788 W
	N 75° W	12.00	789 G
	N 75° W	12.00	790 W
	N 75° W	12.00	791 G
	N 75° W	12.00	792 W
	N 75° W	12.00	793 G
	N 75° W	12.00	794 W
	N 75° W	12.00	795 G
	N 75° W	12.00	796 W
	N 75° W	12.00	797 G
	N 75° W	12.00	798 W
	N 75° W	12.00	799 G
	N 75° W	12.00	800 W

69

Total number of Acres 32,296.54

Survey Designated	By Whom Surveyed	Date of Contract	Amount of Survey	When Surveyed	When paid for and due in the full term of year
Township lines	A. L. King	Oct. 24 1856	17. 31. 95	2. 9. 1857	3. 9. 1858
Subdivisions	do	do	69. 21. 02	1. 1. 1858	1. 1. 1859
Subdivisions	Total & Clark	Nov. 17 1858	5. 74. 31	2. 9. 1859	

The above Map of Township N. 10 North of Range N. 6 West of the Principal Meridian Michigan is strictly conformable to the field notes of the survey thereof on file in this Office, which have been examined and approved.

Surveyor General's Office,
Grand Rapids, Mich. 5. 1859

C. S. Blair
Deputy