

Township 12 North, Range 15 West Mer. (Mich.)

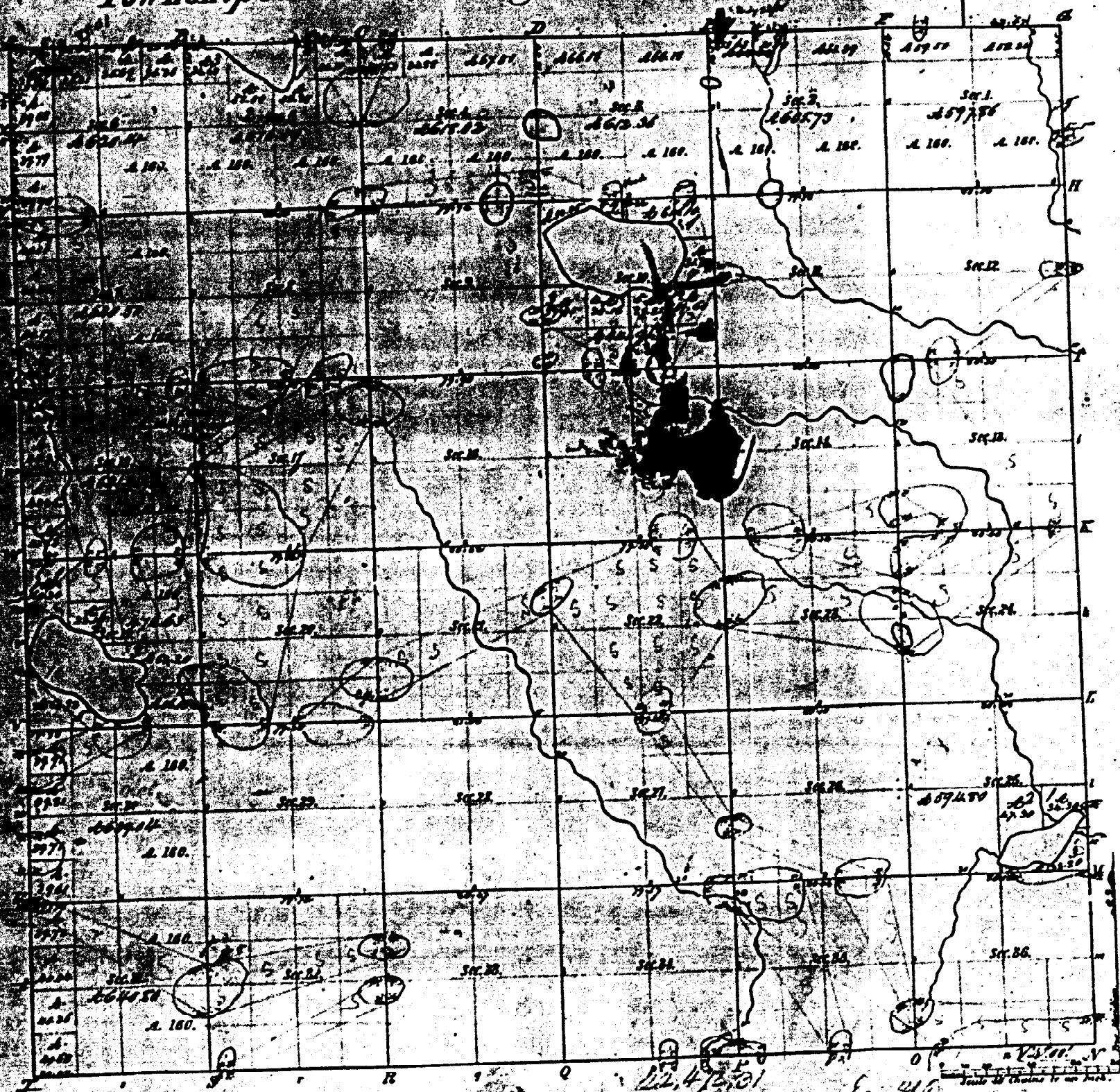

Meanders of Lakes			
Point	Course	Dist.	Point
Lake in Section 25			
By 1831, 1832			
1798	12.00		
1799	12.00		
1800	12.00		
1801	12.00		
1802	12.00		
1803	12.00		
1804	12.00		
1805	12.00		
1806	12.00		
1807	12.00		
1808	12.00		
1809	12.00		
1810	12.00		
1811	12.00		
1812	12.00		
1813	12.00		
1814	12.00		
1815	12.00		
1816	12.00		
1817	12.00		
1818	12.00		
1819	12.00		
1820	12.00		
1821	12.00		
1822	12.00		
1823	12.00		
1824	12.00		
1825	12.00		
1826	12.00		
1827	12.00		
1828	12.00		
1829	12.00		
1830	12.00		
1831	12.00		
1832	12.00		
1833	12.00		
1834	12.00		
1835	12.00		
1836	12.00		
1837	12.00		
1838	12.00		
1839	12.00		
1840	12.00		
1841	12.00		
1842	12.00		
1843	12.00		
1844	12.00		
1845	12.00		
1846	12.00		
1847	12.00		
1848	12.00		
1849	12.00		
1850	12.00		
1851	12.00		
1852	12.00		
1853	12.00		
1854	12.00		
1855	12.00		
1856	12.00		
1857	12.00		
1858	12.00		
1859	12.00		
1860	12.00		
1861	12.00		
1862	12.00		
1863	12.00		
1864	12.00		
1865	12.00		
1866	12.00		
1867	12.00		
1868	12.00		
1869	12.00		
1870	12.00		
1871	12.00		
1872	12.00		
1873	12.00		
1874	12.00		
1875	12.00		
1876	12.00		
1877	12.00		
1878	12.00		
1879	12.00		
1880	12.00		
1881	12.00		
1882	12.00		
1883	12.00		
1884	12.00		
1885	12.00		
1886	12.00		
1887	12.00		
1888	12.00		
1889	12.00		
1890	12.00		
1891	12.00		
1892	12.00		
1893	12.00		
1894	12.00		
1895	12.00		
1896	12.00		
1897	12.00		
1898	12.00		
1899	12.00		
1900	12.00		

6-2
6-2

Total number of Acres 29,473.42

Survey Designated	By Whom Surveyed	Date of Contract	Amount of Survey	When Surveyed	Amount for and due to the State
Township lines	H. Rockfield	Oct. 21, 1836	65. 3/4	1837	3. 1/2
Subdivisions	do	do	65. 4/4	1837	3. 1/2

The above Map of Township 12 North of Range 15 West of the Principal Meridian Michigan is strictly conformable to the field notes of the survey thereof on file in this office which have been examined and approved.

Surveyor General's Office
Ann Arbor, March 15, 1839

[Signature]
Sur. Gen.