

T 3 N R 9 E

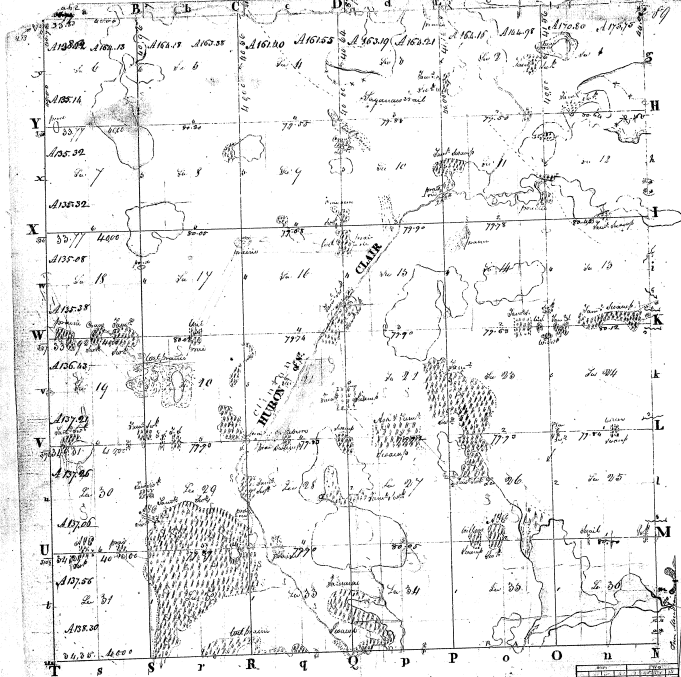

Township No. 3 North of Base Range No. 9 East of Meridian.

Passed to a well with and instructions from Census Office through General of the United States  
 bearing date the twentieth day of January in the year of our Lord one thousand eight hundred and twenty  
 I have advanced laid out and surveyed the above several townships and do hereby certify that it has a  
 such marks and bounds both natural and artificial as are prescribed in this plat and distance with  
 the same as are prescribed in the above and do hereby certify that the above is a true and correct  
 copy of the same as the same is on file in the office of the Surveyor General of the Territory of  
 Colorado at Denver on the 14th day of February 1861.

27-32

27-32

Ⓢ

27-32

27-32

MEANDER SURVEY OF ELIZABETH LAKE  
in Fractional Sections 27, 28, 33 and 34,  
Township 3 North, Range 9 East, Michigan Meridian,  
MICHIGAN.

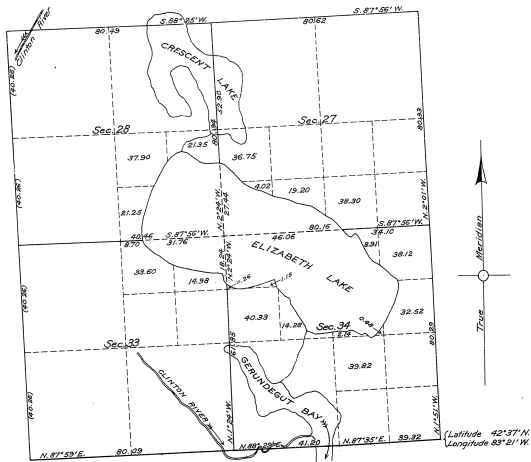

This plat is based upon a meander survey of Elizabeth Lake, the same being shown as a lake upon the official plat approved February 20, 1818, but which was not meandered in the survey executed by Samuel Carpenter, D.S., in 1817. The necessary section lines have been retraced, and the points of intersection of said original lines with the shore line of the lake, as occupied at the date of the original survey, have been monumented as meander corners.

Scale: 20 chains to an inch.  
Survey commenced January 26, 1915.  
Survey completed February 12, 1915.

A. W. S.

202

Department of the Interior,  
General Land Office,  
Washington, D.C., Dec. 27, 1915.

The above plat of Elizabeth Lake, in fractional sections 27, 28, 33 and 34, Township 3 North, Range 9 East, of the Michigan Meridian, Michigan, meandered by Lester L. Clement, U.S. Surveyor, and Donald B. Clement, U.S. Transitman, pursuant to instructions issued by this office, under date of January 11, 1915, is strictly conformable to the field notes of said survey on file in this office, which have been examined and approved.

*[Signature]*  
Commissioner and ex officio  
U.S. Surveyor-General for Michigan.