

Township 1° 46' N. Range 3° 40' W. Mer. Mich.

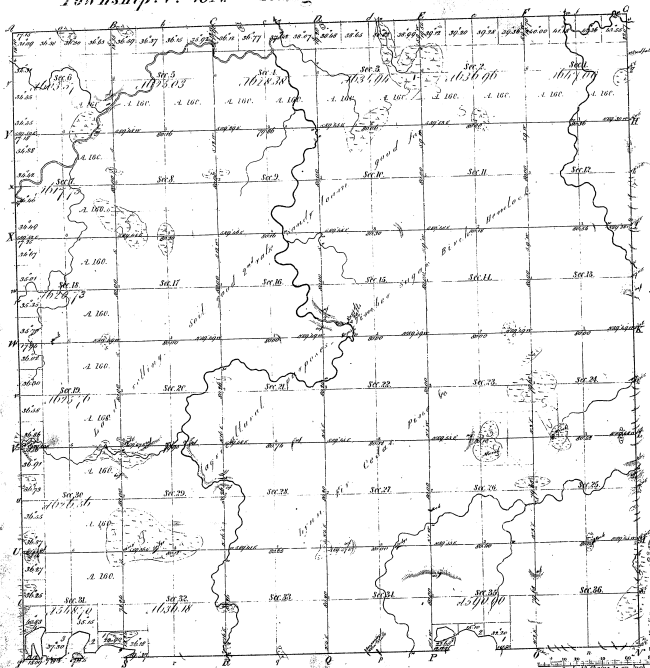

Statement of
 Total Acres 1814 (Part) Acres 1814 (Part) Acres 1814

43-20

43-20

Acres 1814

Total number of Acres 22,762.53

Survey designated	By whom surveyed	Date of Survey	Amount of Survey	When Surveyed	How far west and as to the Section
Township lines	W. M. Adams	April 27, 1857	36 3/4 1/2	1857	1/2 Range 1857
Subdivisions	W. M. Adams	September 1857	22,762.53	1857	1/2 Range 1857

The above map of Township 1° 46' N. of Range 3° 40' W. is a true and correct copy of the original, and is hereby certified to be the full and true copy of the survey as the same has been examined and approved.

Inspector General's Office
 Detroit, Mich. 2, 1857

Charles A. Smith
 Insp. Genl.