

Township 1°52' N. Range 1°58' W. Mer. Alch

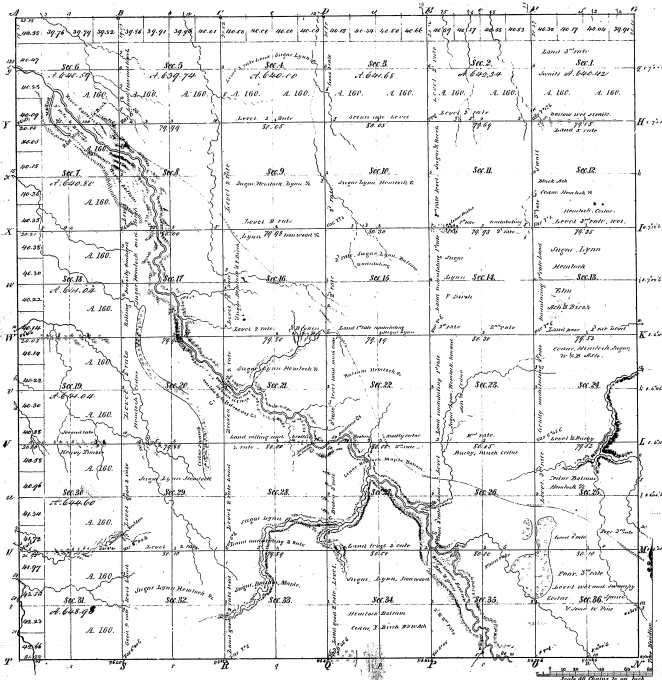

Meridian of

Point	Course	Distance	Point	Course	Distance
1					
2					
3					
4					
5					
6					
7					
8					
9					
10					
11					
12					
13					
14					
15					
16					
17					
18					
19					
20					
21					
22					
23					
24					
25					
26					
27					
28					
29					
30					
31					
32					
33					
34					
35					
36					

11-27

Total number of Acres 20061.11

Survey Designated	By Whom Surveyed	Date of Contract	Amount of Survey	When Surveyed	Amount to and of 1/2 Sec. 36 and 1/2 Sec. 35
Township Area	Wm. A. Briggs	June 24, 1847	76, 51, 24	3 1/2	1184
Subdivisions	Wm. A. Briggs	April 20, 1848	59, 75, 29	3 1/2	1248

The above map of Township 1°52' North of Range 1°58' West of the Principal Meridian Michigan, is a duly confirmed & the field notes of the survey thereon on file in this office, which have been examined and approved.
 Surveyor General's Office
 Detroit, Oct. 16, 1847
 Deane Dixon, Secy